

Learning Laboratory and Community Center: **Positioning the Academic Museum for Success**

Association of Academic Museums & Galleries
Annual Conference

University of Minnesota
June 27-30, 2019

AAMG
Association of Academic Museums & Galleries

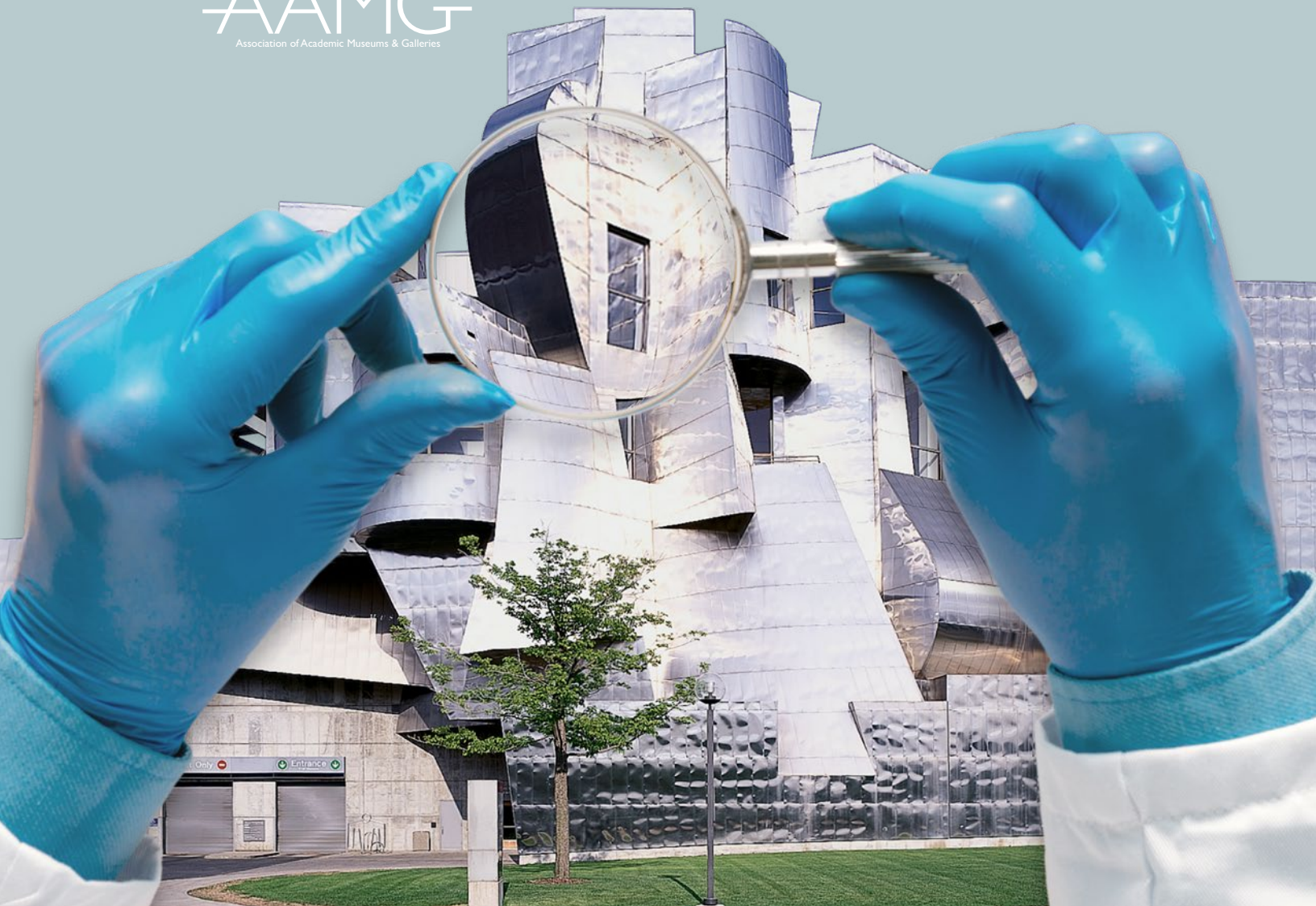

GOLDSTEIN MUSEUM OF DESIGN
HGA GALLERY



September 2, 2017 - January 28, 2018



Goldstein Museum of Design



Bell Museum

Welcome to the 2019 AAMG Annual Conference!



Welcome AAMG members and guests to the University of Minnesota! Beginning on Thursday, June 27, and continuing through Sunday, June 30, 2019, members and friends of the Association of Academic Museums and Galleries are gathering here to explore, share, learn and advance the academic museum field. We are delighted that you have chosen to spend these stimulating and rewarding days in the Twin Cities, supporting the AAMG's 2019 Annual Conference theme *Learning Laboratory and Community Center: Positioning the Academic Museum for Success*. This is AAMG's third Annual Conference in the new multi-day summer format, which has been very successful. Over the last three years the conference submissions for proposals and attendance have been growing, and we expect 300 or more attendees this year!

The Twin Cities is home to regionally and nationally significant museums, including many right here on the University of Minnesota campus. At the Graduate Hotel conference venue, you will meet leaders in every aspect of museum work, including trusteeship, audience development, collections management, curatorial, exhibitions, education, and more. AAMG's annual meetings feature numerous opportunities for discussion—during sessions, after hours, indeed, throughout the week. I hope you will make new friends and take new ideas back to your colleagues that will continue to strengthen our field. If you come early or stay longer, please visit Minneapolis's great museums. We've arranged free admission with your AAMG conference badge or conference registration receipt (check online at aamg-us.org for a complete list of participating venues).

And so, welcome. The members of the AAMG Program Committee have worked hard to offer you the learning experiences and networking that only AAMG can provide for academic museum professionals and students. Thank you, Jill Hartz and Craig Hadley, our AAMG conference directors. Special thanks to our University of Minnesota museum partners—the Bell Museum, the Goldstein Museum of Design, and the Weisman Art Museum, for assisting AAMG with on-site logistics and for hosting the opening and closing receptions. Finally, I would like to also acknowledge all of the sponsors for generously supporting AAMG. Whenever you have an opportunity, please visit their tables at the Graduate Hotel and thank them for their continued support.

If there is anything we can do to enhance your visit and experience, please let us know.

Sincerely,
John Versluis, President, AAMG
president@aamg-us.org

How to Conference



Jill Hartz



Craig Hadley

Welcome to AAMG's 2019 Annual Conference.

It's been a great pleasure to partner with the University of Minnesota and especially three fantastic museum directors: Lyndel King, Lin Nelson-Mayson, and Denise Young. So many people help to make a conference of this scale possible—from museum staff to our AAMG board members, Total Management Solutions and Graduate Hotel staff, students and volunteers. We appreciate all your good work and comradery!

If you came to Eugene (2017) or Miami (2018), the program format will look familiar—with just a few changes. All events, unless otherwise noted, are held in the Graduate Hotel on the University of Minnesota campus. Here's a quick overview:

- **Thursday:** Registration opens at 3 pm and our registration desk will be staffed throughout the conference. If you have a question, start there. **Roundtables** begin at 3:30 pm These offer informal opportunities to dialogue around topics critical to museum work. Our **Opening Reception**, 5:30 – 7:30 pm, is just down the street at the Frederick R. Weisman Art Museum.
- **Friday:** Registration opens at 8 am and continental breakfast is provided both Friday and Saturday. For the first time, we're offering a **Speed Dating for Emerging Professionals** at 8 am If you're new to the museum field or a more seasoned professional willing to mentor our next generations, please join us. Our **Welcome** begins at 9:00 am in the Ballroom and continues with the quick-paced, high-energy **Throwdowns**. We'll get your adrenaline going and then raise it with coffee breaks in the morning and afternoon. Each day has one morning and two afternoon sessions (with four panels in each). We're in the Ballroom for lunch, so find a topic table—**Lunchtime Conversation**—that interests you. We've added a **Poster Session Cocktail Hour** beginning at 4:30 pm, so take some time to hear and recognize the work of your colleagues. Then, you've either signed up for a **Networking Dinner** (6 pm) or you're on your own.

- Following a continental breakfast, Saturday's program begins at 9:00 am with AAMG's **Annual Business Meeting** and our illustrious **Keynote** speaker and former AAM president, Dr. Ford Bell. We continue with three sessions during the day and **Lunchtime Conversations**. Before the final panel session, please be sure to visit our **Sponsorship Marketplace** and thank those who help make our conference possible. **Closing Receptions** will be held at the Goldstein Museum of Design and the Bell Museum. We've arranged for bus transportation to and from the receptions—look for volunteers and signage in the lobby.
- **Sunday:** Breakfast is on your own. If you've signed up for a **Workshop**, make sure you know where it's being held (see conference program for details).
- **And, please, tell us how we're doing.** We're offering **Listening Sessions** during lunch and after the Saturday sessions. AAMG's board really wants to know if our organization is meeting your needs and expectations, how you'd like to be involved, and what more we could do. Remember to complete the survey we'll be sending soon after the conference. If you have suggestions for next year's theme or future university locations, please let us know.

Thanks for coming!

Jill Hartz
hartz@uoregon.edu

Craig Hadley
craighadley@depauw.edu

2019 AAMG Annual Conference Committee

Conference Committee

Tracy Fitzpatrick, Vice President, Programs, AAMG Board
Director, Neuberger Museum of Art, Purchase College, State University of New York

Craig Hadley, Vice President, Communications, AAMG Board
Director & Curator / Assistant Professor, Peeler Art Center, DePauw University

Jill Hartz, President Emerita, AAMG Board
Executive Director, Jordan Schnitzer Museum of Art, University of Oregon

Judith Kirk, Vice President, Development, AAMG Board
Assistant Director, Mathers Museum of World Cultures, Indiana University

Joseph Mella, Treasurer, AAMG Board
Director, Vanderbilt University Fine Arts Gallery

Jamaal Sheats, At-Large, Student Engagement, AAMG Board
Director & Curator / Assistant Professor, University Galleries, Fisk University

John Versluis, President, AAMG Board
Dean, Texas Heritage Museum, Hill College

University of Minnesota:
Lyndel King, Director and Chief Curator, Frederick R. Weisman Art Museum
Lin Nelson-Mayson, Director, Goldstein Museum of Design
Denise Young, Executive Director, Bell Museum

Roundtable Coordinator

TBA

Workshop Coordinator

Frederica Simmons, undergraduate, Art History and Communication Studies (double major), University of Minnesota

Poster Coordinator

Sabrina Ford, undergraduate student, Studio Art major and Horticulture minor, University of Minnesota

Conference Registration

Sheila Guston and Jen Wilkes, Total Management Solutions

Graphic Design

Mike Bragg, Graphic Design Manager, Jordan Schnitzer Museum of Art, University of Oregon

Social Media Coordinators

Alexandra Chamberlain, Assistant Director and Curator of Exhibitions and Education, Peeler Art Center, DePauw University
Lauren Nichols, Development Program Manager, Jordan Schnitzer Museum of Art, University of Oregon

Volunteer Photographer

Obafemi Ogunleye, Ph.D., Comparative and International Development Education, University of Minnesota

Thursday, June 27

| | |
|-----------------------|---|
| 3:00 – 5:00 pm | Registration <i>Graduate Hotel (second floor, hallway)</i> |
| 3:30 – 5:00 pm | Roundtables: Join a Facilitated Discussion on a Special Topic Graduate Hotel (second floor, breakout rooms) <i>Weisman Art Museum</i> |
| 5:30 – 7:30 pm | Opening Reception and Registration <i>Frederick R. Weisman Art Museum</i> |

Positioning Cultural Heritage Collections for Success

In our current moment of political tension, social turmoil, economic pressure, and disciplinary dynamism, how do we define “success” for cultural collections (anthropological, archaeological, historic, and other “people-centered modalities”)? How do we demonstrate success to key supporters and stakeholders? Share your experiences, challenges, and ideas for how we, as museum professionals, can strategically negotiate aspirations and institutional realities related to our cultural heritage collections to achieve success.

Facilitator:

- Christina J. Hodge, Academic Curator and Collections Manager, Stanford University Archaeology Collections

Campus Connections: In the Galleries and Beyond

Every staff member and space in a museum is a teaching opportunity. By widening our reach beyond typical departmental relationships and activities, we can foster new campus partnerships and increase the quantity and quality of student interactions. Share your experiences creating campus connections that encouraged student learning and engagement opportunities. Hear about the new and exciting ways that other attendees have utilized the academic atmosphere to further their missions.

Facilitator:

- Kate Wanberg, Associate Registrar and Preparator, Chazen Museum of Art, University of Wisconsin-Madison

Gallery Pedagogies: Models of Curricular Exhibitions in University Museums

This Roundtable will discuss strategies and models for exhibitions that are tethered to academic courses. Participants are encouraged to share case studies addressing how their project aligned with a course, outlining its overarching goals, acknowledging any challenges, and sharing final outcomes. All types of museums and course connections are welcome.

Facilitator:

- Berit Ness, Assistant Curator for Academic Initiatives, Smart Museum of Art, University of Chicago

We Are Still In: Collaborative Opportunities Addressing Climate Change in Support of a Sustainable Future

Climate change is perhaps the most urgent issue affecting our world, but with the U.S. withdrawal from the Paris Agreement, new types of advocacy and collaboration are urgently needed now. We Are Still In is a national coalition committed to the goals of the Paris Agreement, which brings cultural institutions as well as business, tribes, healthcare, faith-based organizations, and many more together to address environmental sustainability. Let’s learn from one another about how our institutions are supporting this initiative through facility, program, and community practices and what more we can do.

Facilitator:

- Emily Johnsen, Gallery Manager, University Galleries and Co-Chair of the Sustainability Committee, William Paterson University; volunteer, AAM’s Environment and Climate Network, WASI Team Member

Thursday, June 27

Art, Activism and Community Engagement in University Galleries and Museums

This Roundtable welcomes conversation about the museum as a space for challenging exhibitions and artist interventions that inspire conversations with on- and off-campus communities. How can we spark civic engagement, nurture interdisciplinary practices, build inclusion and raise support?

Facilitators:

- Linda Corbin-Pardee, Senior Student Services Coordinator, University of Wisconsin-Milwaukee Union Art Gallery
- Molleen Theodore, Associate Curator of Programs, and Emily Arensman, Program Fellow, Yale University Art Gallery

Iteration and Display: Exploring Intersecting Audiences through Curatorial Experiments

The hybrid gallery-classroom is a powerful incubator space for myriad interpretive strategies that connect academic and public audiences. This roundtable discussion explores how academic museums can effectively leverage study galleries to test new ideas.

Facilitators:

- Elizabeth Gallerani, Curator of Mellon Academic Programs, Williams College Museum of Art
- Elizabeth Manekin, Head of University Programs and Academic Projects, Ackland Art Museum, University of North Carolina at Chapel Hill

5:30 – 7:30 pm

**Opening Reception
and Registration**

Frederick R. Weisman Art Museum

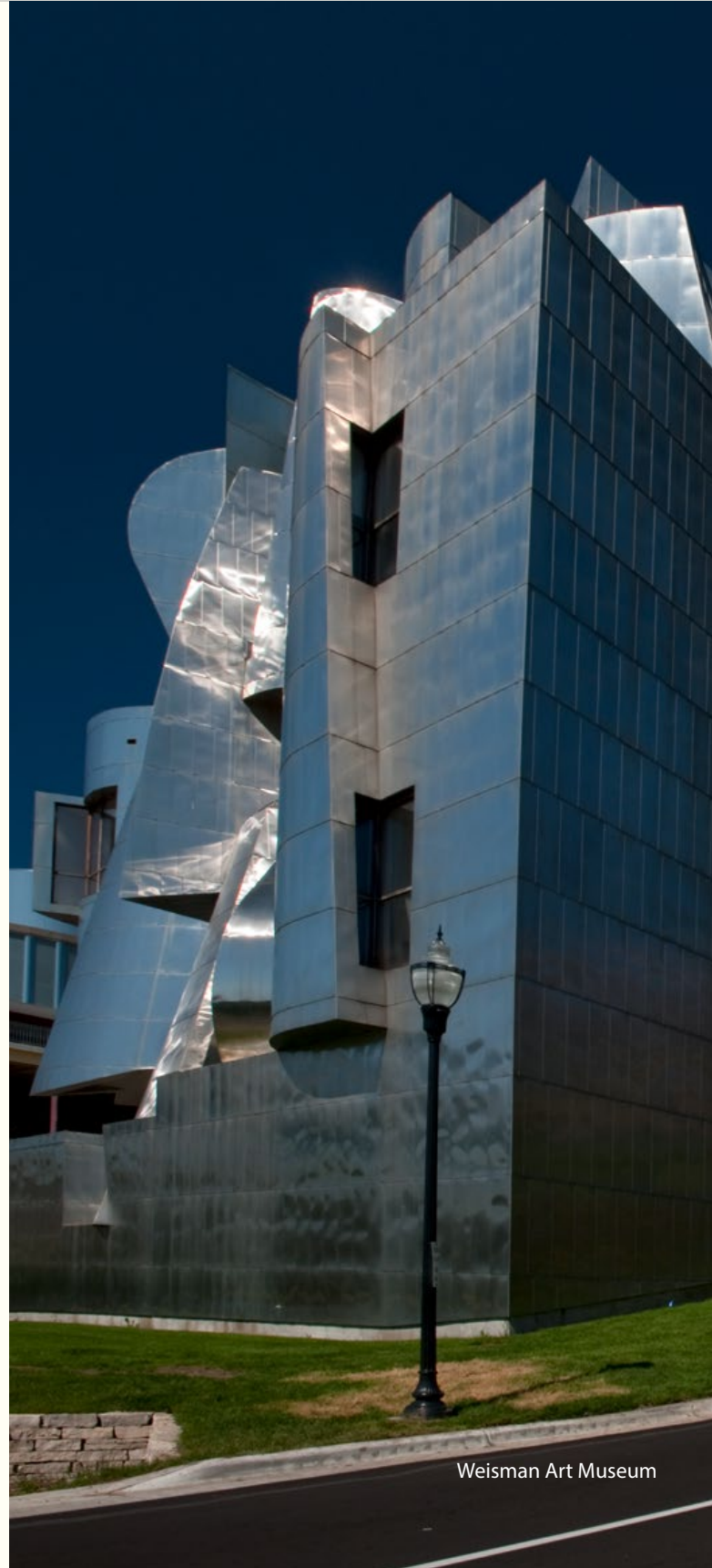

Weisman Art Museum

Friday, June 28

All Friday events from 8:00 am to 5:30 pm are at the Graduate Hotel (second floor).

| | |
|-------------------------|--|
| 8:00 am | Registration and Continental Breakfast <i>Hallway</i> |
| | Speed Networking Event for Emerging Museum Professionals <i>Breakout Room TBA</i> Join your academic museum colleagues for breakfast and spend some time networking with seasoned pros (and other young professionals!) in a small group setting. |
| 9:00 am | Welcome: John Versluis, AAMG President <i>Ballroom</i> |
| 9:15 am | 20 x 5 x 11 THROWDOWNS Emcees: Jamaal Sheats and Kristina Durocher <i>Ballroom</i> |
| 10:15 – 10:45 am | Coffee Break <i>Hallway</i> |
| 10:45 – 12:00 pm | Panel Session 1 <i>Breakout Rooms</i> |
| 12:00 – 1:30 pm | Buffet Lunch/ Lunchtime Conversations <i>Ballroom</i> |
| 1:30– 2:45 pm | Panel Session 2 <i>Breakout Rooms</i> |
| 2:45 – 3:15 pm | Coffee Break <i>Hallway</i> |
| 3:15 – 4:30 pm | Panel Session 3 <i>Breakout Rooms</i> |
| 4:30 – 5:30 pm | Poster Session Cocktail Party <i>Second floor hallway</i> |
| 6 pm | Affinity Dinners <i>Off-site Restaurants</i> |

Throwdown Presentations 20 images x 5 minutes x 11 topics

—lead the conference program this year. The high-energy and quick-paced format offers students and long-time professionals an opportunity to share a special program or practice.

Talking Heads: Creating Dialogue in Polarized Communities

- Jodi Lynn McCoy, Interim Gallery Director and Instructor, Department of Art and Design, Indiana State University

Not Choosing Sides: Engaging Campus and Community in Public Programming

- Julie McLean, Coordinator of Public Programs, Herbert F. Johnson Museum of Art, Cornell University
- Annamarie Ventura, Andrew W. Mellon Coordinator of Student Engagement, Herbert F. Johnson Museum of Art, Cornell University

Student-Led Community Outreach at Fisk University Galleries for New and Expanding Families

- Dartisha Mosley, Undergraduate Student, Fisk University
- Nikoo Paydar, Assistant Curator, Fisk University Galleries, Fisk University

Students Helping Students: Co-Creating University Museum Programming

- Sydney Marshall, Education Graduate Assistant, Museum of Natural History, University of Colorado

Friday, June 28

It's Electrifying! An Interactive Approach to Museum Collections

- Florencia Pierri, Curator, The Sarnoff Collection at The College of New Jersey

Audience as Artist

- Yukiko Stranger-Galey, Exhibits and Design Manager, Beaty Biodiversity Museum, The University of British Columbia

Minimal Supervision: Student Agency in University Galleries and Collections

- Jay Buchanan, START Gallery Manager, Wake Forest University

Auburn on the Move: Arts and Innovation at a Land-Grant University

- Ausu Anaraki, Development Officer, and Charlotte Hendrix, Project Management Specialist, Marketing and Communications, Jule Collins Smith Museum of Fine Art, Auburn University

Making Connections: Hands-on Workshops based on Collections

- Kelsea Gustavson, Teen and Undergraduate Engagement Coordinator, The University of Pennsylvania Museum of Archaeology and Anthropology

Accessible to All: Using Medical School Resources to Design Inclusive Art Museum Programs

- Allison Taylor, Head of Education & Community Engagement, The Mildred Lane Kemper Art Museum

The Layered Museum: An Argument for Embodied Virtual Experience

- A.C. Newton, Graduate Assistant, Museum of Natural History, University of Colorado

10:15 – 10:45 am Coffee Break

Hallway

Network with your colleagues and Visit our Posters and Sponsor Tables.

Resume Reviews (sign up required at the registration table).

10:45 – 12:00 pm Panel Session 1

Breakout Rooms

Academic Museums as Agents of Change: Negotiating the Politics and Realities of Higher Education

This panel offers a wide-ranging discussion about the power dynamics at play in the museum and its parent institution. What curatorial practices, curricular engagement programs, and community outreach efforts allow us to further the missions of both and address the economic structures of the academy, the art world, and our own communities? How can we bring greater value to the museum's work and change perceptions that devalue museums and their staff? How can museums become agents of change in the academy?

The Politics and Economics of the Academic Museum

- Jodi Kovach, Curator of Academic Programs, Gund Gallery, Kenyon College
- Katie Knowles, Curator, Avenir Museum, and Assistant Professor, Department of Design & Merchandising, Colorado State University

Curatorial Practice as Labor in the Academy

- Claire Kovacs, Director, Augustana Teaching Museum of Art, Augustana College
- Meredith Lynn, Assistant Curator, Museum of Fine Arts, Florida State University

Curating Relationships

- Moderator and Presenter: Boris Oicherman, Cindy and Jay Ihlenfeld Curator for Creative Collaboration, Weisman Art Museum, University of Minnesota

Campus Cross-Pollination between Art Museums and Natural History Museums

Sharing collections and research, addressing sensitive political and social issues, and creating interdisciplinary courses are just some of the strategies discussed in this international panel that aims to encourage partnerships among art, anthropology, history, and science museums.

A Student-Centered Collaboration to Improve Native American Representation in Yale Museums

David Heiser, Director of Student Programs, Yale Peabody Museum of Natural History

- Katherine McCleary, Woodbridge Fellow and 2016 NAAI Intern, Yale University
- Leah Shrestinian, Gallery Guide and 2106 NAAI Intern, Yale University Art Gallery

Building Common Ground across Disciplines: The University of Cambridge Museums Consortium

- Liz Hide, Director, The Sedgwick Museum of Earth Sciences, University of Cambridge, UK
- Miranda Stearn, Head of Learning, Fitzwilliam Museum, UK

A New Way of Doing Museum

- Edith Doron, Senior Program Manager of Carnegie Nexus, Carnegie Museums of Pittsburgh

Connecting Zoology and Art

- Erin Fletcher, Director, Ross Art Museum, Ohio Wesleyan University
- Moderator: Jennifer Reynolds-Kaye, Curator of Education and Academic Outreach, Yale Center for British Art

There and Back Again: Off-site Storage Facilities for Academic Museums

As collections expand, the need for storage becomes more pressing, especially when on-site storage is no longer an option. This panel explores the ways that art and natural history museums address this need through off-site storage spaces and the risks and benefits such situations create.

- Annette Van Aken, Senior Registrar, Frederick R. Weisman Art Museum, University of Minnesota
- Chris White, Collections Manager, Jordan Schnitzer Museum of Art, University of Oregon
- Moderator: Beverly Balger Sutley, Registrar, Palmer Museum of Art, The Pennsylvania State University

Becoming a Part of Campus Conversations: Reaching Out to Bring Students In

This panel will explore the benefits of extracurricular programming, collaborations with student groups, and student-driven co-curricular initiatives.

- Erin Northington, Manager of Student Engagement Programs, Harvard Art Museums
- Annmarie Ventura, Andrew W. Mellon Coordinator of Student Engagement, Herbert F. Johnson Museum of Art, Cornell University
- Moderator and Presenter: Isadora Italia, Campus Engagement Coordinator, Hood Museum of Art

12:00 – 1:30 pm **Buffet Lunch/Lunchtime Conversations**
Ballroom

Lunchtime Conversations

Grab a lunch and join colleagues for moderated conversation around themes ranging from pedagogy to annual giving to how AAMG can do more for you.

Undergraduate Museum Career Development: Internships, Fellowships, and Object-based Learning

- Tiffany Miller, Arthur E. Klausner Collections and Community Outreach Fellow, Richard E. Peeler Art Center DePauw University

Connecting Museum Collections to Communities On and Off Campus

- Neal Matherne, Mellon Museum-Library Collection Ethnographer, Tang Teaching Museum and Scribner Library, Skidmore College
- Hannah Quaintance, PhD Candidate in Anthropology and Graduate/Teaching Assistant for the Cravens Collection, University at Buffalo Art Galleries, SUNY

Visual Thinking Strategies: Teaching, Training, and Evaluation

- Alexandra Chamberlain, Assistant Director and Curator of Exhibitions and Education, Richard E. Peeler Art Center, DePauw University
- Brad Hokanson, Mertie Buckman Professor of Design, University of Minnesota
- Kayla Birt-Flegal Access and Outreach Services Librarian, DePauw University Libraries

Innovative Annual Giving Campaigns

- Cindy Cox, Membership Officer, Jule Collins Smith Museum of Fine Art, Auburn University
- Dennis Harper, Curator of Collections and Exhibitions, Jule Collins Smith Museum of Fine Art, Auburn University
- Charlotte Hendrix, Project Management Specialist, Marketing and Communications, Jule Collins Smith Museum of Fine Art, Auburn University
- Douglas Perkins, Associate Director, Operations and Finance, Middlebury College Museum of Art

Listening Session: Calling All Students! What's AAMG Doing Right? What Should it be Doing?

- John Wetenhall, Director, The George Washington University Museum & The Textile Museum; Vice President, Strategic Planning, AAMG Board

1:30– 2:45 pm Panel Session 2

Breakout Rooms

Friends with Benefits: Collection-Sharing Initiatives

Increasingly, academic museums in the 21st century need to be nimble and creative in order to respond adequately to the prohibitive cost of art, limited budgets, and the new ways in which younger generations encounter and respond to art. This panel presents several collections-sharing initiatives as case-studies for a dialogue about the role of such initiatives and potential ways to expand, deepen, and multiply them to help institutions better fulfill their missions and reach their goals.

- Margaret Conrads, Director of Curatorial Affairs and Strategic Initiatives, Crystal Bridges Museum of Art
- Elizabeth Finch, Lunder Curator of American Art, Colby College Museum of Art
- Cheryl Hartup, Curator of Academic Program and Latin American and Caribbean Art, Jordan Schnitzer Museum of Art, University of Oregon
- Moderator: Ena Heller, Bruce A. Beal Director, Cornell Fine Art Museum Rollins College

A Literal “Looking Lab”: Scientific Collaboration with the Academic Art Museum

This panel explores partnerships between colleagues in STEM fields – sciences, technology, engineering, and mathematics – and the art museum, highlighting how these multifaceted collaborations can produce ground-breaking results in research, teaching, and conceptions of a collection. t

New Insights on Old Objects: Maximizing the Impact of Collaborative Technical Research

- Brittany Rubin, Print Room Curatorial Assistant, Herbert F. Johnson Museum of Art, Cornell University
- Louisa Smieska, Staff Scientist, Cornell High Energy Synchrotron Source, Cornell University • Moderator and Presenter: Leah Sweet, Curatorial Coordinator of Academic Programs, Herbert F. Johnson Museum of Art, Cornell University

Perspectives on the Evolution of Cultural Heritage Technology Research

- Renee Stein, Chief Conservator and Lecturer, Michael C. Carlos Museum, Emory University

STEAM Power: Creating Educational Opportunities in a Cultural Heritage Research Hub

- Katherine Schilling, Associate Conservation Research Scientist, Institute for the Preservation of Cultural Heritage, Yale University

Building Relationships through NAGPRA

One aspect of a successful museum is compliance with the Native American Graves Protection and Repatriation Act (NAGPRA) of 1990. Compliance is required for all academic museums and collections that receive any federal funding and hold Native American human remains and cultural items. This panel will present two case studies that demonstrate how colleges and universities are engaging with NAGPRA and address how other academic museums can position themselves for success and build positive relationships through NAGPRA compliance.

- Lourdes Henebry-DeLeon, NAGPRA Program Director, Department of Anthropology, Central Washington University
- Ellen M. Lofaro, NAGPRA Coordinator & Curator of Archaeology, Department of Anthropology, The University of Tennessee
- Angela Neller, Curator, Wanapum Heritage Center
- Moderator: Anne Amati, NAGPRA Coordinator/Registrar, University of Denver Museum of Anthropology

Looking Back to Move Forward: Commemorating Controversy in the Campus Museum (Double Session: Part 1 of 2)

Museums have long been considered a site of commemoration, a place where visitors can look back in remembrance, honor, or even dismay. At the same time, commemorations of difficult times, touchy subjects, and painful members are often controversial, both within and outside the museum and the academy, and can have ripple effects on funding, staffing, and even the continuing existence of the museum. This panel offers best practices in dealing with commemorative programs that can forge stronger ties with our constituents and create a wider vision of the world for our students.

- Heather Campbell, Curator of Museum Programs, and Martha Wright, Assistant Curator of Academic and Public Engagement, University of Richmond Museums
- Keidra Daniels Navaroli, Assistant Director and Curator, Ruth Funk Center for Textile Arts, Florida Institute of Technology
- Glori Simmons, Director, Thacher Gallery, University of San Francisco
- Moderator and Presenter: Amber R. Clifford-Napoleone, Professor of Anthropology and Director, McClure Archives and University Museum, University of Central Missouri

2:45 – 3:15 pm Coffee Break

Hallway

Network with your colleagues and visit our Posters and Sponsor Tables.

Resume Reviews (sign up required at the registration table)

3:15 – 4:30 pm Panel Session 3

Breakout Rooms

Looking Back to Move Forward: Commemorating Controversy in the Campus Museum (Double Session: Part 2 of 2)

Museums have long been considered a site of commemoration, a place where visitors can look back in remembrance, honor, or even dismay. At the same time, commemorations of difficult times, touchy subjects, and painful members are often controversial, both within and outside the museum and the academy, and can have ripple

effects on funding, staffing, and even the continuing existence of the museum. This panel offers best practices in dealing with commemorative programs that can forge stronger ties with our constituents and create a wider vision of the world for our students.

- Heather Campbell, Curator of Museum Programs, and Martha Wright, Assistant Curator of Academic and Public Engagement, University of Richmond Museums
- Keidra Daniels Navaroli, Assistant Director and Curator, Ruth Funk Center for Textile Arts, Florida Institute of Technology
- Glori Simmons, Director, Thacher Gallery, University of San Francisco
- Moderator and Presenter: Amber R. Clifford-Napoleone, Professor of Anthropology and Director, McClure Archives and University Museum, University of Central Missouri

Changing the Conversation: University Students as Art Museum Docents

Panelists will discuss the benefits, challenges, obstacles, and results of creating a student docent program.

- Rebecka A. Black, Visual Arts & Community Programs Coordinator, Texarkana Regional Arts & Humanities Council
- Sage Kincaid, Associate Curator of Education, Georgia Museum of Art, University of Georgia
- Kathryn Medill, Audience Experience Coordinator, Arizona State University Art Museum
- Moderator: Carissa DiCindio, Assistant Professor, University of Arizona

The Gallery as Teaching Lab: Pre-service Training and Museums

This panel will offer alternative best practices on ways museums can help new teachers enrich their teaching practices by modeling collaborative learning, visual and media literacy strategies, and a dialogic, inquiry-based approach.

- Rebecca Krucoff, Visiting Instructor, Art and Design Education, Pratt Institute
- Kendall Reingold, M.A.T. Student, Urban Teacher Training Collaborative Scholars Program, Tufts University
- Annie V. F. Storr, Resident Scholar, Women's Studies Research Center, Brandeis University
- Moderator and Presenter: Elizabeth Canter, Manager of Academic Programs, Tufts University Art Galleries

Preaching to the Choir? Creating Meaningful Dialogue Around Divisive Issues

Police violence, domestic violence, race and incarceration inequalities, religious diversity, immigration policies, GMOs, and the food industry: How do these issues impact our communities and wider culture, and how can academic museums facilitate truly meaningful conversations about these topics? This panel shares strategies, discusses failures and successes, and aims to engage attendees in a discussion about we can facilitate difficult dialogue while remaining true to our missions.

- Scott Bishop, Curator of Academic and Public Programs, Jule Collins Smith Museum of Fine Art, Auburn University
- Karen Howard, Director, Winthrop University Galleries
- Christina McClellan, Collections Manager and Coordinator of Exhibitions ad Programs, Abrams-Engel Institute or the Visual Arts, University of Alabama at Birmingham
- Moderator: Dennis Harper, Curator of Collections and Exhibitions, Jule Collins Smith Museum of Fine Art, Auburn University

4:30 – 5:30 pm **Poster Session Cocktail Party** *Second floor hallway*

Enjoy refreshments while listening to colleagues present their poster research.

6 pm **Affinity Dinners*** *Off-site Restaurants*



Affinity Dinners

| Topic | Host |
|--|--|
| Advisory Boards and Governance | Jill Hartz |
| Curating and Social Practice | Nicole Crawford |
| Faculty engagement | Joseph Mella |
| History Museums | John Versluis |
| International Collaboration | Anja Chavez |
| Membership and Fundraising | Louanne Greenwald |
| Mission, Vision, and Strategic Planning | Natalie Marsh |
| Small Museum Accreditation | Craig Hadley |
| Student Curated Exhibits | Katie Covey |
| Students and Emerging Museum Professionals | John Wetenhall and Alexandra Chamberlain |

*Affinity dinners require advance conference registration. Dinner hosts will communicate meeting location with registered guests via email.



Image courtesy of Risdon Photography risdonfoto.com

Ford W. Bell

Ford W. Bell began his tenure as president and CEO of the American Alliance of Museums, in Washington, D.C., in June 2007 and retired from that position in 2015. Bell has a longstanding relationship with the museum community. He helped raise \$103 million as co-chair of the Minneapolis Institute of Arts' "Bring Art to Life" capital campaign, completed in 2006, and he served as chair of the organization's board from 2003 to 2005. He also served on the Advisory Board of the James Ford Bell Museum of Natural History at the University of Minnesota from 1983 to 2007. Currently, he serves on the boards of the Minnesota Historical Society and the National Music Museum at the University of South Dakota.

Bell has more than forty years of experience as a nonprofit executive, board chair, donor, trustee and educator. From 1995 to 2005, he served as President and CEO of the Minneapolis Heart Institute Foundation at Abbott Northwestern Hospital, a prominent clinical cardiovascular research organization and a nationally recognized provider of community heart health education. He most recently served as President of the Hennepin Health Foundation at Hennepin County Medical Center in Minneapolis from August 2015 until retiring in April of 2018.

A board-certified veterinary oncologist, Bell served on the staff of the University of Minnesota's College of Veterinary Medicine, where he taught and did clinical research in comparative oncology, from 1982 to 1996. He served as trustee and elder at Westminster Presbyterian Church in Minneapolis, and co-chaired that institution's \$16 million capital campaign. From 1993 to 2007, he served as chair of the James Ford Bell Foundation. An educator for much of his career, Bell also served as a trustee of Connecticut College in New London, Connecticut, from 1998 to 2007.

Saturday, June 29

Note: All Saturday events from 8:00 – 5:00 pm are at the Graduate Hotel (second floor). Closing receptions will be held at the Goldstein Museum of Design and the Bell Museum.

| | |
|--|---|
| 8:00 am | Registration and Continental Breakfast |
| 9:00 am | AAMG Annual Business Meeting Ballroom |
| 9:30 am | Keynote: Ford W. Bell, DVM, former President of the American Alliance of Museums |
| 10:15 – 10:45 am | Coffee Break Hallway |
| Network with your colleagues and visit our Poster and Sponsor Tables. Resume Reviews (sign up required at the registration table). | |
| 10:45 – 12:00 pm | Panel Session 4 Breakout Rooms |
| 12:00 – 1:00 pm | Buffet Lunch/Lunchtime Conversations Ballroom |
| 1:30 – 2:45 pm | Panel Session 5 Breakout Rooms |
| 2:45 – 3:15 pm | Coffee Break Hallway |
| 3:15 – 4:30 pm | Panel Session 6 Breakout Rooms |
| 4:30 – 5:30 pm | Listening Session: Calling All Students |
| 5:00 – 6:00 pm | Closing Reception at the Goldstein Museum of Design |
| 6:00 – 7:30 pm | Closing Reception at the Bell Museum <i>Transportation will be provided to/from the Graduate Hotel.</i> |

10:45 – 12:00 pm Panel Session 4 *Breakout Rooms*

Beyond the Ivory Tower: Public History for Community Engagement and Social Justice

This panel highlights three exhibitions that leveraged institutional histories as a tool for community engagement and social justice.

- Noah Barth, Public Historian, Minneapolis, MN
- Elizabeth DeGrenier, Graduate Student, Heritage Studies and Public History, University of Minnesota
- Kacie Lucchini Butcher, Public Historian & Heritage Preservationist, Minneapolis, MN
- Denise Pike, Public Historian, Minneapolis, MN
- Moderator: Greg Donofrio, Associate Professor and Director of Heritage Studies and Public History Program, University of Minnesota
- Commentator: Kevin Murphy, Professor of History, Heritage Studies and Public History, University of Minnesota

A Museum Without Walls: Advocating for the Arts through a Campus Loan/Public Art Program

Unlike their non-academic counterparts, university museums and galleries can enhance their missions by democratizing their collections far beyond their facilities' physical walls. This expansion through Campus Loan programs and public art programs allows the collections to reach their full potential by exposing the entire campus to the arts. This panel discusses the challenges and benefits of such programs.

- Madison Auten, Gallery Manager and Curator, Union Art Gallery, University of Wisconsin-Milwaukee
- Jocelyn Boigenzahn, Director, Scarfone/Hartley Gallery/Lecturer in Museum Studies, Department of Art+Design, University of Tampa
- Lana Burgess, Associate Clinical Professor, School of Visual Art and Design/Faculty Curator, McKissick Museum, University of South Carolina
- Lynn Marsden-Atlass, Executive Director, Arthur Ross Gallery/University Curator, University of Pennsylvania
- Moderator: Emily Dittman, Associate Director, Syracuse University Art Galleries

University Museums as Agents for Decolonization on Campus

For decades anthropology museums have been re-contextualizing and re-considering their collections, responding to re-conceptualizations of civic responsibility, local and source/descendant communities, research, and classes. This panel considers the anthropological academic museum's role as an advocate for decolonizing higher education by facilitating conversations about decolonization through course and campus partnerships.

- Christina Hodge, Academic Curator and Collections Manager, Stanford University Archaeology Collections, Stanford Archaeology Center
- Lainie Schultz, Academic Partnerships Coordinator, Peabody Museum of Archaeology and Ethnology, Harvard University
- Moderator and Presenter: Stephanie Mach, Academic Coordinator, University of Pennsylvania Museum of Archaeology and Anthropology

Curatorial Partnerships with Professors and Students

This panel explores the museum as learning laboratory for faculty and undergraduate students, particularly in the curation of temporary exhibitions.

Guest Curating with Undergraduate Partners: Summer Research Collaborations

- Moderator: MacKenzie Moon Ryan, Assistant Professor of Art History, Rollins College
- Morgan Snoop '20 and Cristina Toppin '21, Rollins College

Experiential Learning: Student Curators, Academic Courses, and the College Art Museum

- Richard Saunders, Director, Middlebury College Museum of Art/Professor, History of Art and Architecture, Middlebury College

From Intern to Employment: New Accessions and Student Involvement

- Scott Bishop, Curator of Academic and Public Programs, Jules Collins Smith Museum of Art, Auburn University

Teaching Exhibition Design at a Liberal Arts College

- Leah Niederstadt, Assistant Professor of Museum Studies and Curator of the Permanent Collection, Department of Art/Art History, Wheaton College

12:00 – 1:00 pm Buffet Lunch/Lunchtime Conversations

Ballroom

Lunchtime Conversations

Grab a lunch and join colleagues for moderated conversation around themes ranging from pedagogy to annual giving.

Cultivating Global Citizens through Curricular-based Models and Methodologies

- Leslie Elsasser, Curator of Education, University of South Florida Contemporary Art Museum

Grant Opportunities at the National Endowment for the Humanities

- Margaret Walker, Program Officer, Division of Preservation and Access, National Endowment for the Humanities

Measuring Impact: Evaluating the University Museum

- Katie Covey, Director of Student Engagement, Frederick R. Weisman Art Museum, University of Minnesota
- William Crow, Director and Professor of Practice, Lehigh University Art Galleries
- John LaValle, Ph.D., Assistant Professor, College of Education & Human Development, Organizational Leadership, Policy and Development, University of Minnesota

Listening Session: Calling All Members! What's AAMG Doing Right? What Should it be Doing?

- AAMG Board members

1:30 – 2:45 pm Panel Session 5

Breakout Rooms

Dealing with the Tough Stuff: Promoting Civic Dialogue in the Academic Art Museum

Academic museums often enjoy a level of institutional freedom to address contemporary social issues, such as institutional racism, decolonization, income inequality, and LGBTQ+ rights. This panel explores how museums address these “tough subjects” through exhibitions and associated programming aimed at promoting a role for museums in the community as sites of civic dialogue and exchange.

#UNLOAD: *Guns in the Hands of Artists*

- Michelle DiMarzo, Curator of Education and Academic Engagement, Fairfield University Art Museum

“Confess: An Installation by Trina McKillen” An Artist’s Perspective on the Clerical Abuse Crisis

- Karen Rapp, Director & Curator, Laband Art Gallery, Loyola Marymount University

A Vexed Citizenship: Puerto Rico and Pablo Delano’s ‘The Museum of the Old Colony’

- Amy Halliday, Gallery Director, Hampshire College Art Gallery

Yoav Horesh: Aftermath

- Kristina Durocher, Director, Museum of Art, University of New Hampshire
- Moderator: Carey Weber, Executive Director, Fairfield University Art Museum

Student Educator Programs: Creating Student Communities and Community-Focused Students

Panelists share their strategies in engaging students in gallery guide and educator programs that strengthen university goals and foster new generations of students with deep connections to their peers, museums, and the community

- Aimee Shapiro, Director of Programming and Engagement, Anderson Collection at Stanford University
- Theresa Sotto, Associate Director, Academic Programs, Hammer Museum, UCLA
- Moderator and Presenter: Sarah Linn, Research Liaison, University of Pennsylvania Museum of Archaeology and Anthropology

On the Front Lines of Museum-Library Collaboration

This panel explores recent Museum-Library partnerships, supported by The Andrew W. Mellon Foundation, that, through their alignments, enhance their missions and their academic value.

- Alison Gilchrest, Program Officer, Arts and Cultural Heritage, The Andrew W. Mellon Foundation
- Jacinta Johnson, Associate Conservator, Andrew W. Mellon Initiative, University of Kansas Libraries and Spencer Museum of Art, University of Kansas
- Christina Larson, Andrew W. Mellon Fellow in Academic Engagement, Lowe Art Museum and University Libraries, University of Miami
- Moderator and presenter: Jenny Kreiger, Mellon Postdoctoral Scholar in Museum-Library Collaboration, Jordan Schnitzer Museum of Art and University Libraries, University of Oregon

Co-curricular Connections: Student Clubs and After-School Activities in the Academic Museum

Presenters will discuss specific initiatives that have proven successful in creating a space within the academic museum for students outside the classroom setting.

- Alexandra Chamberlain, Assistant Director and Curator of Exhibitions and Education, Peeler Art Center, Depauw University
- Abby Groth, Associate Curator of Public Programs, Sheldon Museum of Art, University of Nebraska-Lincoln
- Moderator: Lauren Nichols, Development Program Manager, Jordan Schnitzer Museum of Art, University of Oregon

2:45 – 3:15 pm **Coffee Break** *Hallway*

Network with your colleagues and visit our Posters and Sponsor Tables.

Resume Reviews (sign up required at the registration table.)

3:15 – 4:30 pm **Panel Session 6** *Breakout Rooms*

Good/Bad Advisory Board Member: Recruit, Engage, and Empower the Best Candidates for Your Museum's Board

In times of shifting university priorities and an eagerness to establish academic museums as relevant and essential, an agile, efficient, and committed advisor board is essential. These panelists share strategies and experiences to help you find and secure strong leaders for your board, keep them engaged as vocal advocates for your mission, and learn how to manage under-performing or difficult personalities.

- Margaret Benjamin, Advisory Board Member, Louisiana State University Museum of Art and Weatherspoon Art Museum, University of North Carolina Greensboro
- Pamela Hoehn-Saric, Board Member, Gund Gallery, Kenyon College, and Chair, Smart Museum of Art, University of Chicago
- Lee Pfannmuller, Board Chair, Bell Museum of Natural History, University of Minnesota
- Gina Russo, Advisory Board Member, Hood Museum of Art, Dartmouth College
- Moderator: Mary Baily Wieler, President Museum Trustee Association

Museums and the Medical Humanities: Art, Illness and Empathy

This panel discusses museum collaborations with medical humanities classes that encourage close readings of works depicting or related to illnesses across cultures and eras. Papers will address how such class discussions challenge students to empathize with the ill and to relate to different cultural approaches to sickness and caregiving.

- Aimee Hunt, Associate Academic Curator, The Fralin Museum of Art at the University of Virginia
- Cassandra Mesick Braun, Curator of Global Indigenous Art, Spencer Museum of Art, University of Kansas
- Veronica White, Curator of Academic Programs, Princeton University Art Museum
- Moderator: Jodi Kovach, Curator of Academic Programs, Gund Gallery, Kenyon College

Innovative Leadership Training in the 21st Century

This session will examine several innovations in professional

development that respond to the 21st century. Looking at the efforts of leading museum studies programs will give us an opportunity to consider options that will position us for success in the future. Our panel represents successful approaches to museum training including new courses, teaching methods, collaborations, and mentorships.

Innovation in Museum Studies

- Martha Morris, Associate Professor Emerita, Museum Studies Program, Corcoran School of Arts and Design, George Washington University

JHU Museum Studies Response to the Changing Needs of the Field

- Phyllis Hecht, Director, M.A. in Museum Studies, Johns Hopkins University

Bonding, Bridging, and Building Communities of Practice

- Juilee Decker, PhD, Associate Professor, Museum Studies, College of Liberal Arts, Rochester Institute of Technology

Making the Exceptional Standard: Case Studies and New Strategies for Non-traditional Exhibition and Engagement

- Andrew J. Saluti, Assistant Professor, Program Coordinator, Graduate Program in Museum Studies, School of Design, Syracuse University

Piloting a Museum Practice MA: An Apprenticeship Model

Jill Hartz, Executive Director, Jordan Schnitzer Museum of Art, University of Oregon

- Respondent: Heather Nolin, PhD, Deputy Director for Exhibitions, Programming, and Education, Yale University Art Gallery
- Moderator: Anja Chávez, PhD, Director, University Museums, Colgate University

Laboratories of Engagement: Creative Structures for New Audiences

Today's campus art museums serve both the largest and most demographically diverse student body in history. This panel offers case studies and proven frameworks for how university museums and develop co-curricular collaborations with their student bodies to develop meaningful relationships and transformative experiences.

- Rachel Heisler, Assistant Curator of Education, Academic Programs, Snite Museum of Art, University of Notre Dame
- Michael Janairo, Head of Communications and Strategic Initiatives, Tang Teaching Museum, Skidmore College
- Moderator and presenter: Katie Covey, Director of Student Engagement, Frederick R. Weisman Art Museum, University of Minnesota

4:30 – 5:30 pm **Listening Session:
Calling All Students**

Meet with AAMG Board member John Wetenhall at the Graduate Hotel bar and tell us how AAMG can better meet your interests and needs!

5:00 – 6:00 pm **Closing Reception at the
Goldstein Museum of Design**

6:00 – 7:30 pm **Closing Reception at the
Bell Museum**

*Transportation will be provided
from the Graduate Hotel.*



Poster Sessions

Please visit the poster presentation cocktail reception on Friday, June 28, 4:30 – 5:30 pm. Posters can also be viewed during coffee breaks.

Academic Writing, Online Exhibitions: Mentoring Student Curators on Google Arts & Culture

- Laura Minton, Curatorial Assistant, Prints & Drawings, Museum of Fine Arts, Houston

Building Community with Student-Curated Pop-Up Exhibitions

- Claire Koelling, undergraduate student, Gund Gallery, Kenyon College

Collaborating with Faculty and Students: Interdisciplinary Object-based Learning in Academic Museums

- Michelle Jones, graduate student, Museum Studies, San Francisco State University

EMPIRE: Exploring the Influence of Tulane University on the City of New Orleans

- David Allen Burns and Austin Young, Fallen Fruit
- David Banush, Dean of Libraries, Tulane University
- Tom Friel, Coordinator for Interpretation and Public Engagement, Newcomb Art Museum
- Monica Ramirez-Montagut, Director, Newcomb Art Museum, Tulane University

From the Ground Up: Building an Academic Partnership Between the Barry Art Museum and the Center for Educational Partnerships at Old Dominion University

- Joanna K. Garner, Executive Director, and Alexandra Carver, Education Specialist, The Center for Educational Partnerships, Old Dominion University
- Amber Inwood, Museum Education Specialist, Barry Art Museum, Old Dominion University
- Jutta-Annette Page, Executive Director, Barry Art Museum, Old Dominion University Museum Foundation

Initiating and Building New Partnerships on Campus

- Kimberly Musial Datchuk, Assistant Curator of Special Projects, University of Iowa Stanley Museum of Art; Visiting Assistant Professor, College of Education, University of Iowa

Islam and the Sceptered Isle: Creating a New Interpretation for an Old Period Room

- Alyssa Gregory, Public Historian, MA Heritage Studies and Public History, UM
- Ashley Patton, Doctoral Candidate, Art History, UM
- Noam Sienna, Doctoral Candidate, History/Museum Studies, UM

Mixed Methods: Multifaceted Engagement with a College's Many Communities

- Carolina Blatt-Gross, Assistant Professor and Program Coordinator of Art Education, The College of New Jersey
- Margaret Pezalla-Granlund, Director, The College of New Jersey Art Gallery
- Florencia Pierri, Curator, The Sarnoff Collection, The College of New Jersey

Poster Sessions

New Relationships: Rewriting Gallery Education

- Elizabeth King, Gallery Interpretation and Public Program Manager, Harn Museum of Art, University of Florida
- Jason Pallas, Manager of Community Engagement and Arts Learning, Smart Museum of Art, University of Chicago

Open to Intersections: Academic/Public Programs at the Harvard Art Museums

- Molly Ryan, Programs Manager, Division of Academic and Public Programs, Harvard Art Museums

Taking a Baby Step: Student Ambassadors for Community Outreach

- Youmi Efurd, Curator, Richardson Family Art Museum & Gallery, Wofford College

The Power of Partnership: Telling the Story of A. Hays Town

- Susan Gottardi, Manager of Marketing and Design, Paul and Lulu Hilliard University Art Museum, University of Louisiana at Lafayette

University of Central Oklahoma Archives Internship: Students to Manage Collection, Research, and Curate

- Shikoh Shiraiwa, Archives Specialist, Archives and Special Collections, Max Chambers Library, University of Central Oklahoma

Visual Thinking Strategies and The Framework in the Undergraduate Classroom: Research as Inquiry and Scholarship as Conversation through the Lens of a University's Art Collection

- Kayla Birt-Flegal Access and Outreach Services Librarian, DePauw University Libraries
- Alexandra Chamberlain, Assistant Director and Curator of Exhibitions and Education, Richard E. Peeler Art Center, DePauw University

Investigating History through Exhibition Design: A Case Study on Wim Gilles

- Alisdair MacRae, Independent Scholar

Fisk Museum Leadership Program

- Genevieve Antoine, undergraduate student, Tuskegee University
- Ambar Gonzalez, undergraduate student, Fisk University
- Taryn Nurse, undergraduate student, Fisk University
- Stephane Prieto Ponce, undergraduate student, North Carolina Central University
- Robert Riojas, undergraduate student, Texas Southern University
- ArJae Thompson, undergraduate student, Fisk University
- Michael Marie Thomas, undergraduate student, Texas Southern University
- Dominique Williams, undergraduate student, Spelman College
- Jordan Wright, undergraduate student, North Carolina Central University



Sunday Workshops

Workshops run 3-4 hours in length, beginning at 9 am and require additional registration to participate.

Art as a Catalyst for Conversations: Languages in Museums

Using the Colby College Museum of Art's "You're Speaking My Language" program as a model, Valle-Mancilla will provide practical ways museums can collaborate with language departments, local language teachers, and community members. Participants will learn how to use collections when working with new, current, and native language learners and how the museum can serve as an effective extension of the classroom, where reading, speaking, writing, and listening all happen at once.

Workshop presented by:

- Miriam Valle-Mancilla, Linde Family Foundation Coordinator of Academic Access, Colby College Museum of Art

Minimum Attendance: 8 (capped at 20)

Location: Weisman Art Museum, University of Minnesota, 333 E River Pkwy, Minneapolis, MN 55455

Hours: 9am - noon

Cost: \$50 per person

Implementing NAGPRA

Workshop participants will learn about the requirements of NAGPRA, including who needs to comply, who has standing to make requests, what types of items are eligible for repatriation under the law, and when and how to consult. Workshop leaders will provide examples of NAGPRA procedures, such as creating inventories and summaries, and review the lines of evidence museums can use to make cultural affiliation determinations as well as what happens if none can be made. Nueller brings twenty-nine years of experience managing archaeological, ethnographic, and archival collections. She provides technical expertise in repatriation matters to the Wanapum Band of Priest Rapids. Amati is responsible for NAGPRA compliance as well as ensuring that the University of Denver is cultivating and maintain good relations with tribes.

Workshop presented by:

- Anne Amati, NAGPRA Coordinator/Registrar, Museum of Anthropology, University of Denver
- Angela Neller, Curator, Wanapum Heritage Center, Beverly, MA

Minimum Attendance: 8 (capped at 20)

Location: Weisman Art Museum, University of Minnesota, 333 E River Pkwy, Minneapolis, MN 55455

Hours: 9am - noon

Cost: \$50 per person

Sunday Workshops

PERCEIVE: The Art of Making Meaning

What's the difference between looking and seeing? How can slowing down, a luxury we don't often have, enhance and support productive conversations, effectively bridging differing viewpoints, and create a tolerance for ambiguity? Yung brings more than twelve years of gallery teaching experience to this workshop, which explores—through improve, performance, and team-building activities, how slowing down offers new processes and approaches to involve visitors, promote productive conversations, and make connections across the university and community. Yung has facilitated Perceive workshops locally and nationally to diverse audiences, including K-12 students, pre-service teachers, university students, teachers, artists, community groups, university departments, and corporations.

Workshop presented by:

- Jamee Yung, Director of Education, Frederick R. Weisman Art Museum, University of Minnesota

Minimum Attendance: 10 (capped at 35)

Location: Weisman Art Museum, University of Minnesota, 333 E River Pkwy, Minneapolis, MN 55455

Hours: 9am - noon

Cost: \$50 per person

Secrets to Reaccreditation Success for Academic Museums

Over 16 percent of all accredited museums are academic museums. And in the next five years 13 percent of all reaccreditation reviews will be of academic museums.

Reaccreditation reviews of academic museums have some unique aspects in light of their organizational structure and other factors. And the reaccreditation process has changed (for the better) so it will be new to museum staff that have done the process before.

The workshop is based on over four decades of lessons learned from hundreds of institutions and thousands of reviews. It will help staff involved in their museum's upcoming reaccreditation review learn effective approaches to preparing for and managing each step of the process in order to have the smoothest and most successful experience.

Through presentations and hands-on exercises the attendees will experience the following, with an emphasis on unique aspects for academic museums:

- What to expect, and effective approaches, for each step in the process—from preparation through the self-study and site visit to the final decision
- What's different about the new reaccreditation process
- Strategies for success to maximize benefits, minimize delays, and avoid setbacks due to common pitfall
- Learn what accreditation standards are—in plain language—and how they apply to academic museums
- Get advice from peers who have done it before, served on the Accreditation Commission, and been site visit reviewers

Workshop presented by:

- Julie Hart, Senior Director, Museum Standards & Excellence, American Alliance of Museums

Minimum Attendance: 8 (capped at 20)

Location: Rapson Hall (Room 225), University of Minnesota, 89 Church Street Se, Minneapolis, MN, 55455

Hours: 9am - noon

Cost: \$50 per person

Schedule at a Glance

Thursday 27, 2019

- 3:00 – 5:00 pm** **Registration** | *Graduate Hotel (second floor, hallway)*
- 3:30 – 5:00 pm** **Roundtables: Join a Facilitated Discussion on a Special Topic Graduate Hotel**
(second floor, breakout rooms) Weisman Art Museum
- 5:30 – 7:30 pm** **Opening Reception and Registration** | *Frederick R. Weisman Art Museum*

Friday 28, 2019

All Friday events from 8:00 am to 5:30 pm are at the Graduate Hotel (second floor).

- 8:00 am** **Registration and Continental Breakfast** | *Hallway*
Speed Networking Event for Emerging Museum Professionals | *Breakout Room TBA*
Join your academic museum colleagues for breakfast and spend some time networking with seasoned pros (and other young professionals!) in a small group setting.
- 9:00 am** **Welcome: John Versluis, AAMG President** | *Ballroom*
- 9:15 am** **20 x 5 x 11 THROWDOWNS | Emcees: Jamaal Sheats and Kristina Durocher**
Ballroom
- 10:15 – 10:45 am** **Coffee Break** | *Hallway*
- 10:45 – 12:00 pm** **Panel Session 1** | *Breakout Rooms*
12:00 – 1:30 pm **Buffet Lunch/ Lunchtime Conversations** | *Ballroom*
- 1:30– 2:45 pm** **Panel Session 2** | *Breakout Rooms*
- 2:45 – 3:15 pm** **Coffee Break** | *Hallway*
- 3:15 – 4:30 pm** **Panel Session 3** | *Breakout Rooms*
- 4:30 – 5:30 pm** **Poster Session Cocktail Party** | *Second floor hallway*
- 6 pm** **Affinity Dinners** | *Off-site Restaurants*

Schedule at a Glance

Saturday 29, 2019

| | |
|--|--|
| 8:00 am | Registration and Continental Breakfast |
| 9:00 am | AAMG Annual Business Meeting <i>Ballroom</i> |
| 9:30 am | Keynote: Ford W. Bell, DVM, former President of the American Alliance of Museums <i>Ballroom</i> |
| 10:15 – 10:45 am | Coffee Break <i>Hallway</i> |
| Network with your colleagues and visit our Poster and Sponsor Tables. Resume Reviews (sign up required at the registration table.) | |
| 10:45 – 12:00 pm | Panel Session 4 <i>Breakout Rooms</i> |
| 12:00 – 1:00 pm | Buffet Lunch/Lunchtime Conversations <i>Ballroom</i> |
| 1:30 – 2:45 pm | Panel Session 5 <i>Breakout Rooms</i> |
| 2:45 – 3:15 pm | Coffee Break <i>Hallway</i> |
| 3:15 – 4:30 pm | Panel Session 6 <i>Breakout Rooms</i> |
| 4:30 – 5:30 pm | Listening Session: Calling All Students |
| 5:00 – 6:00 pm | Closing Reception at the Goldstein Museum of Design |
| 6:00 – 7:30 pm | Closing Reception at the Bell Museum <i>Transportation will be provided to/from the Graduate Hotel.</i> |

Maps

Event Space Floor Plan

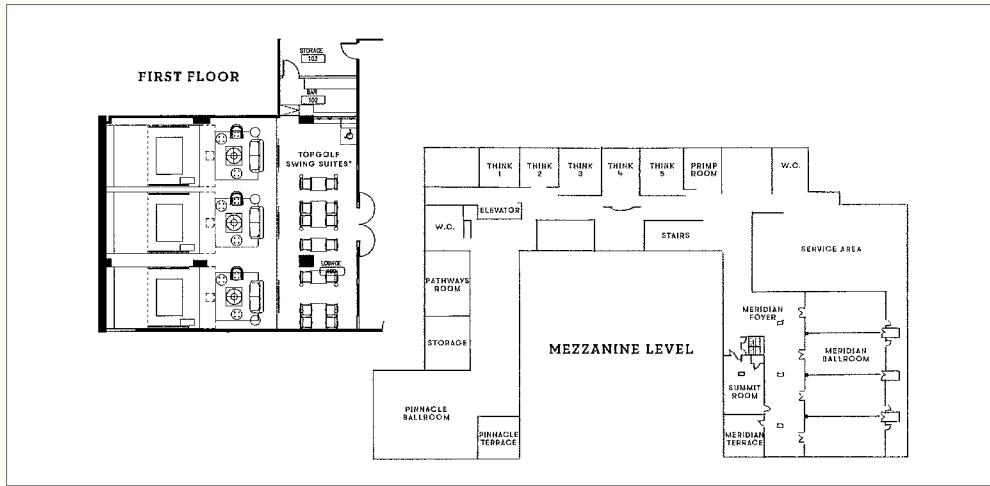

East Bank Campus (Graduate Hotel and Weisman Art Museum)

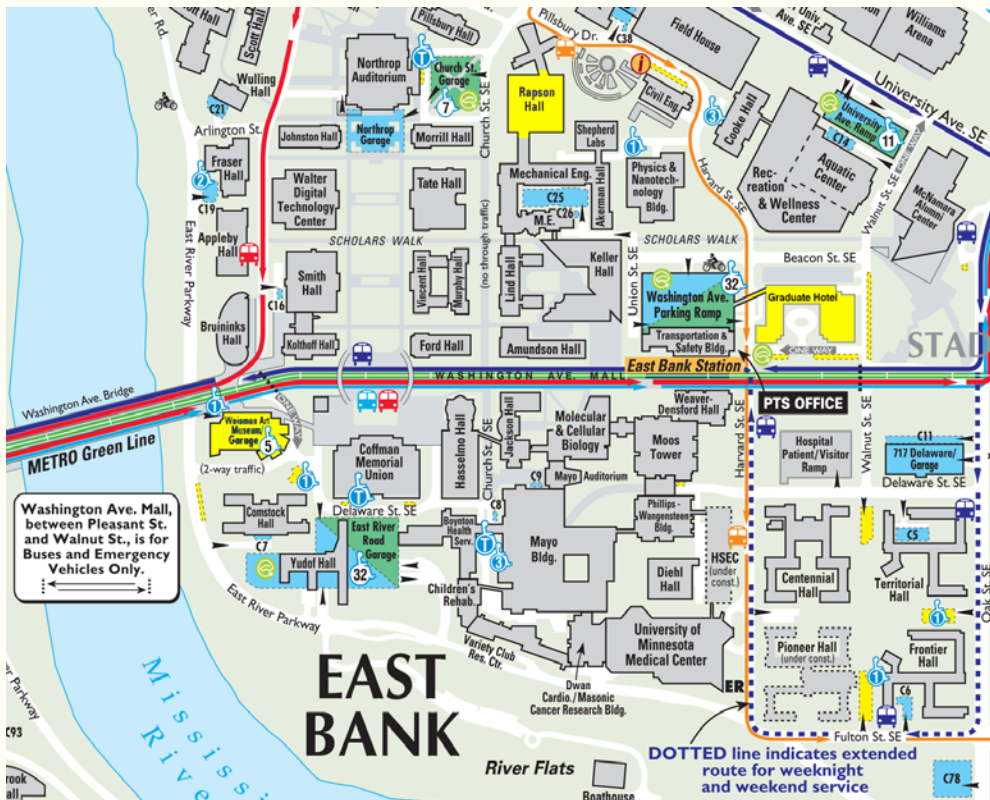

Maps

St. Paul Campus (Bell Museum and Goldstein Museum of Design)

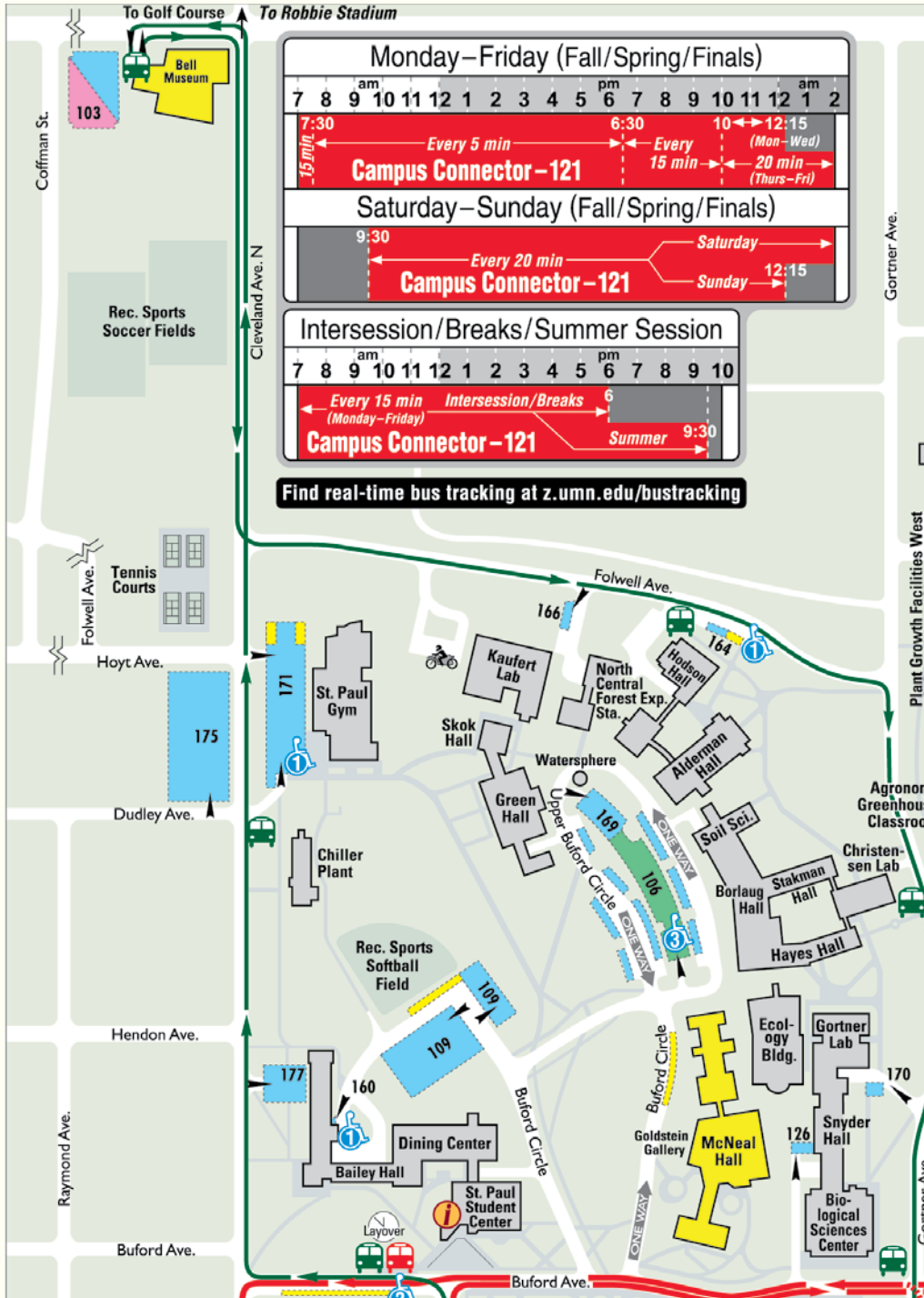

Contacts

Internet Access:

Connect to network (SSID): Graduate Convention

Enter password: AAMG19

Need help? Visit the registration desk for further assistance with Wi-Fi.

Kyle Berg

Director of Event Technology - PSAV

office: 612.362.6662

direct: 507.829.9215

fax: 612.362.6661

General Questions:

Sheila Guston

Executive Director-AAMG

Total Management Solutions

Sheila@totmgtSol.com

Jennifer Wilkes

Assistant to the Executive Director-AAMG

Total Management Solutions

201-895-8400

AAMGdirector@gmail.com

Helpful Links

At the University of Minnesota

Weisman Art Museum

<https://wam.umn.edu/>

Regis Center for Art

<https://cla.umn.edu/art/galleries>

Bell Museum

<https://www.bellmuseum.umn.edu/>

Goldstein Museum of Design

<http://goldstein.design.umn.edu/>

The Raptor Center

<https://www.raptor.umn.edu/>

Minneapolis Attractions

We've arranged free admission to the following Minneapolis venues with your AAMG conference badge or conference registration receipt. Most venues will accept conference registration between June 27 - 30, 2019. Visit our website for the most up-to-date listing of participating venues:

<https://www.aamg-us.org/wp/2019-annual-conference/excursions/>