

Association
of Academic
Museums and
Galleries
Annual
Conference

**Why Museums
Matter: The
Teaching
Museum Today**

**June 22-25, 2017
Eugene, Oregon**

Jordan Schnitzer Museum of Art (JSMA) and
Museum of Natural and Cultural History (MNCH)

AAMG | conference program

Welcome to AAMG's 2017 Annual Conference!



Thank you for joining us this June as we explore the roles of academic museums, galleries, and collections on campus and beyond. From training new generations of students to creating new partnerships aimed at inclusion and equity, from developing sustainable operations to testing new curatorial models, you are revitalizing your institutions, and, in the process, your communities. Your work is transforming our field and inspiring all of us to think more deeply, engage more fully, and share our successes and challenges with one another. All of us on the AAMG Board of Directors are grateful for your participation, and we look forward

to learning from you. We hope the conference is everything you are expecting (if not more), and we invite you to become more involved in AAMG.

Jill Hartz, President, AAMG

AAMG Conference 2017 Host Committee

Jill Hartz, Conference Director and Co-Host

President, Association of Academic
Museums and Galleries

Executive Director, Jordan
Schnitzer Museum of Art (JSMA)

Ann Craig, Conference Co-Host

Director of Public Programs,
Museum of Natural and Cultural
History (MNCH)

Lauren Nichols, Conference Coordinator

Campus Outreach Coordinator,
MNCH; Graduate Student

Doug Blandy, Conference Advisor and Sponsor

Senior Vice Provost for Academic
Affairs, University of Oregon

Breanna DeMontigny, Conference Assistant and Silent Auction Coordinator

Graduate Student

Eric Dil, Conference Evaluation and Poster Session Coordinator *Adjunct Faculty, University of Oregon*

Andrea Hadsell, Conference Volunteer Coordinator

Graduate Student

Ruth Hyde, Conference Volunteer Manager

Office and Volunteer Coordinator, MNCH

Jamie Leaf, Conference Events and Hospitality Advisor

Visitor Services Coordinator and
Facility Rental Coordinator, JSMA

Isaac Marquez, Conference Hospitality Advisor and Sponsor

Interim Cultural Services Director,
City of Eugene Cultural Services

Paul Nordquist, Conference Technology Coordinator

Technology and Event Support
Assistant, JSMA

Linda Norris, Conference Hospitality Advisor

Convention Services Manager,
Travel Lane County

Alice Parman, Conference Events Advisor and Sponsor

Museum Consultant and Arts
Administration Instructor,
University of Oregon

Judi Pruitt, Conference Events Advisor

Associate Director and Visitor and
Member Services, MNCH

Rebecca Mellnik, Scheduling Coordinator

Erb Memorial Union, University of
Oregon

Samuel H. Kress Foundation Presenter Scholarships

Elizabeth Coulter
Jennifer Reynolds-Kaye
Sarah Taubner

Samuel H. Kress Foundation Student Scholarships

Willa Ahlschwede
John Jay Boda
Marianna Finke
Rebecca Jacobs
Catalina Jaramillo
Jonathan Kelley
Allison Meyeette
Giulia Pagano
Ashley Simmons
Jess Simpson
Rachel Straughn-Navarro
Greta Taylor
Angelee van Allman
Natalie Wadle

CultureSpots Student Scholarship

Brittany Halberstadt

Four Colour Print Group Student Scholarship

Jessica Bocinski

Travelers Student Scholarship

Lauren Nichols
Breanna DeMontigny

KEYNOTE SPEAKERS

Dustin Growick

Friday, June 23, 9:15-10:15 a.m.



Dustin Growick spearheads both Museum Hack's Audience Development initiatives and is their Team Lead for Science. He received his MA in Anthropology from SUNY Stony Brook and has worked in education at the New York Hall of Science, the American Museum of Natural History, and as a traditional classroom teacher. Now, at the Metropolitan Museum of Art, the American Museum of Natural History, and with museum colleagues around the world, Dustin specializes in creating unique, engaging, and educational adult museum experiences that attract and capture new audiences. In his spare time, Dustin enjoys running, playing soccer and being the world's biggest proponent of the #dinoselfie.

Wendy Red Star

Saturday, June 23,
9:15-10:15 a.m.



Artist Wendy Red Star works across disciplines to explore the intersections of Native American ideologies and colonialist structures, both historically and in contemporary society. Raised on the Apsáalooke (Crow) reservation in Montana, Red Star is informed both by her cultural heritage and her engagement with many forms of creative expression, including photography, sculpture, video, fiber arts, and performance. An avid researcher of archives and historical narratives, Red Star seeks to incorporate and recast her research, offering new and unexpected perspectives in work that is at once inquisitive, witty and unsettling. Intergenerational collaborative work is integral to her practice, along with creating a forum for the expression of Native women's voices in contemporary art.

Red Star has exhibited in the United States and abroad at venues including the Metropolitan Museum of Art, Fondation Cartier pour l' Art Contemporain, Domaine de Kerguéhennec, Portland Art Museum, Hood Art Museum, St. Louis Art Museum, and the Minneapolis Institute of Art. She served as a visiting lecturer at such institutions as Yale University, the Figge Art Museum, the Banff Centre, National Gallery of Victoria in Melbourne, Dartmouth College, CalArts, Flagler College, Fairhaven College, and I.D.E.A. Space. In 2015, Red Star was awarded an Emerging Artist Grant from the Joan Mitchell Foundation. In 2016, she participated in *Contemporary Native Photographers and the Edward Curtis Legacy* at the Portland Art Museum and recently mounted a solo exhibition as part of the museum's APEX series.

Red Star holds a BFA from Montana State University, Bozeman, and an MFA in sculpture from the University of California, Los Angeles. She lives and works in Portland, OR.



2:30pm: Registration opens
EMU ballroom

4:00 – 5:15 pm: Roundtables

DIVERSITY (MNCH)*

Engaging Difference: Strategies for Diversity at the Princeton University Art Museum

Juliana Ochs Dweck, Mellon Curator of Academic Engagement, Princeton University Art Museum

Orchestrating Campus and Community Connections with The Music Box: Tampa Bay

Sarah Howard, Curator of Public Art and Social Practice, Institute for Research in Art, and Shannon Annis, Exhibitions Manager/Registrar, University of South Florida Contemporary Art Museum

PUBLIC ART ON CAMPUS (JSMA)*

The Expanded Museum: Public Art at Western Carolina University

Laura Minton, Curator of Collections and Exhibitions, Western Carolina University Fine Art Museum

% for Art on Campus

Chris White, Collections Manager, Jordan Schnitzer Museum of Art

CREATIVE SOLUTIONS FOR EXHIBITIONS & COLLECTIONS MANAGEMENT (JSMA)

Contemporary Exhibitions for Small Galleries

Heather Horn Johnson, Gallery Manager, Sarah Spurgeon Gallery, Central Washington University

Developing and Funding Curricular Resources

Nicolette Meister, Acting Director, Curator of Collections, and Adjunct Assistant Professor of Museum Studies, Logan Museum of Anthropology, and Carolyn Jenkinson, NEH Project Coordinator, Logan Museum of Anthropology, Beloit College

STUDENT PROFESSIONAL DEVELOPMENT (JSMA)

Student Engagement through Professional Development in Academic Museums

Stephanie Hanor, Director, Mills College Art Museum

ENGAGING UNDERGRADS IN UNEXPECTED WAYS, INCLUDING STUDENT CLUBS (MNCH)

Robyn Anderson, Education Coordinator; Lauren Willis, Program and Exhibit Developer; Lauren Nichols, Campus Outreach Coordinator, MNCH, and AAMG Conference Coordinator

Chris Marshall, Curator, Oregon State Arthropod Collection; Dr. Peter Konstantinidis, Curator, Ichthyology Collection; Dr. Melanie Link-Perez, Curator, Oregon State University Herbarium

STANDARDIZING AUDIO DESCRIPTIONS (JSMA)

Audio Description Standards

Jonathan Kelley, Museum Studies student, University of Illinois Chicago, and artist Sam Kirk

MANAGING AND IMPROVING VISITOR SERVICES (JSMA)

Jamie Leaf, Visitor Services Coordinator, JSMA

★
Technical Assistance Sponsor: Museum Hack

Roundtables Sponsor: Museum Store Products

*MNCH: Museum of Natural and Cultural History
JSMA: Jordan Schnitzer Museum of Art

Premier Sponsor: University of Oregon 
Office of Academic Affairs
Lead Sponsors: Samuel H. Kress Foundation
Jordan Schnitzer Family Foundation

22 Thursday
June

5:30 – 8:00 pm: Welcome Reception and Throwdown, EMU Ballroom *(Erb Memorial Union)*

The University of Oregon Welcomes You!

Jill Hartz, AAMG President; Executive Director, Jordan Schnitzer Museum of Art
Ann Craig, Director of Public Programs, The Museum of Natural Cultural and History
Jason T. Younker, Asst. Vice President and Advisor to the President on Sovereignty and Government-to-Government Relations
University of Oregon President Michael Schill
Jordan Schnitzer, Jordan Schnitzer Family Foundation

20x5x8 THROWDOWN: 20 images x 5 minutes x 8 topics

Actor-Network-Theory (ANT) as a Model of Understanding Student-object Interactions in a University Museum

Rachel M. Straughn-Navarro, Assistant Museum Educator, Museum of Art and Archaeology, University of Missouri

Harvard Art Museum's New Art Study Center: Engaging Adult Learners, including Those with Disabilities

Kelley Hirsch, EdM. Candidate, and Jessica Metzger, EdM. Candidate, Harvard Graduate School of Education

From Reaching Out to Reaching Within – A Case Study of Qian Xuesen Library & Museum

Wenjia Qiu, Education Outreach Program Manager, Qian Xuesen Library & Museum

Student-Centered Museum Teaching Without a Museum: The Visual Classroom

Kimberly Musial Datchuk, Visiting Assistant Professor of Art Education, University of Iowa Museum of Art

Supporting Student Research Inside and Out

*Anne Tiballi, Curricular Facilitator, Penn Museum
Presentation co-authored by Sarah Linn, Ph.D. student and Research Liaison, Penn Museum*

Launching the Gund Gallery Art Loan Program: Living with Works of Art

Robin Goodman, Collections Manager and Registrar, with Shayne Wagner and Lewis Turley, Gund Gallery Associate Leaders, Gund Gallery, Kenyon College

Public as Pedagogy: Campus Museums as Centers for Public Intellectual Life

Sonnet Kekilia Coggins, Associate Director for Academic and Public Engagement, Williams College Museum of Art

The Arts-based Community Engagement Model: Training Emerging Professionals

Susan Mann, doctoral student, Museum Education and Exhibitions, Florida State

 **Welcome Reception Sponsor:** Jordan Schnitzer Family Foundation

Scholarship Sponsors: Culture Spots, Four Colour Print Group, Travelers Insurance and Samuel H. Kress Foundation

- 8:00 am: Registration
- 8:30 – 8:45 am: Welcome & Remarks by Doug Blandy, Senior Vice Provost for Academic Affairs
Video Presentation by Laura Lott, President, AAM
- 8:45 – 9:15 am: Annual Meeting
- 9:15 – 10:15 am: **Keynote:** Dustin Growick, Museum Hack
- 10:15 – 10:45 am: Break; Book signing (*Exhibit Makeovers* by Alice Parman)

■ Session 1, 10:45 am – 12 noon

Effective University Museum Boards: Recruitment, Responsibility and Engagement

Cedar + Spruce Room

Category: Governance and Advocacy

Mary Baily Wieler, President, Museum Trustee Association; William Underwood Eiland, Director, Georgia Museum of Art; Dr. Natalie Marsh, Director, The Gund Gallery, Kenyon College; and Dr. Lee Michels, advisory board member, JSMA and MNCH

The University Museum as Collaborative Teaching Partner: Working with Artists and School Districts to Enhance Art Education

Ballroom

Category: Curricular Connections, Diversity and Engagement

Alecia Conrad, Teacher, Penn-Harris-Madison School Corp., Mishawaka, Indiana; Kay Rozzi Antonelli, Assistant Superintendent for Instruction, Penn-Harris-Madison School Corp.; Zachary Tate, artist; and Sarah Martin, Curator of Education, Public Programs, Snite Museum of Art

Establishing a CURE for Biodiversity Literacy in Undergraduate Education: The Impact on Student Learning and Attitudes (in an introductory organismal biology lab course)

Maple Room

Category: Curricular Connections

Teresa J. Mayfield, Manager, UTEP Biodiversity Collections, and Jeffrey T. Olimpo, Assistant Professor, Biological Sciences, University of Texas, El Paso

Language Class Visits

Swindells Room

Category: Curricular Connections

Heather Flaherty, Curator of Education, The Trout Gallery, Dickinson College; Erin McNulty Diaz, Assistant Professor, Dickinson College; Giulia Pagano, student (language major), Dickinson College; Jennifer Reynolds-Kaye, Whitney Payson Fellow, Education Department, Yale University Art Museum; Liz Canter, Gallery Educator and Academic Programs Coordinator, Tufts University Art Gallery; and Veronica White, Curator of Academic Programs, Princeton University Art Museum

12:00 – 1:30 pm: Lunch; Please visit our Sponsor Tables, Poster Sessions (page 15) and Silent Auction

Ballroom

12:00 – 1:30 pm: **Effective Boards: Lunch and Roundtable Discussion:** We'll follow up on hot topics from our morning session on Effective University Museum Boards and dive deeper into critical governance roles. Get to know other university museum trustees, share best practices and war stories, learn from each other, and build a community of peers. Discussion moderated by Rebekah Lambert, Vice President, Arts Consulting Group.

Oak Room

Opening Plenary & Keynote Sponsor: Glavé & Holmes ★

Morning Breaks Sponsor: Sotheby's

Luncheon Sponsor: Tru Vue, Inc.

■ Session 2, 1:30 pm – 2:45 pm

Collaborate, Experiment, Evolve, University Partnerships to Engage K-12 School Communities/The Art of the Deal: What Can Museums Learn from the K-12 Teacher?**Swindells Room**

Category: Curricular Connections/K-12 Outreach

Michael Christiano, Interim Senior Director of Museum Programs, Smart Museum of Art, University of Chicago; Theresa Sotto, Assistant Director, Hammer Museum, UCLA; Amber Geary Spadea, Mellon Educator for School and Community Programs, Wellin Museum, Hamilton College

Transforming Practice: Academic Museums as Incubators for Research and Innovation**Ballroom**

Category: Curricular Connections

Sarah Horowitz, Curatorial Assistant, Picker Art Gallery/Longyear Museum of Anthropology, Colgate University; Christy DeLair, Assistant Curator, Longyear Museum of Anthropology, Colgate University; and Debora Ryan, Adjunct Professor, Graduate Program in Museum Studies, Syracuse University

The Joys and Challenges of Small Staffs: A Discussion about Museums and Galleries with Fewer than Four Employees**Maple Room**

Category: Governance and Administration

Jeffrey Bowen, Director, University of Houston-Clear Lake Art Gallery; Paul Manoguerra, Director, Jundt Art Museum, Gonzaga University; Joseph Mella, Director, Vanderbilt University Fine Arts Gallery; Michiko Okaya, Director, Lafayette College Art Galleries and Art Collections; Carey Weber, Fairfield University Art Museum; and Margaret Walker, Assistant Curator, Vanderbilt University Fine Arts Gallery

Repositioning the Teaching Museum**Cedar + Spruce Room**

Category: Curricular Connections

Place with No Fences: The Academic Art Museum and Anti-departmental Curricular Trends: *Leah Sweet, Mellon Curatorial Coordinator for Academic Programs, Johnson Museum, Cornell University*

Giving STEM a Place at the Table: How to Incorporate STEM-based Learning into Academic History Museums: *Sarah Hopley, Special Collections and Exhibits Librarian, Murray State University*

Random Objects and Meaningful Moments: A Trip to University of Richmond Museums: *Martha Wright, Coordinator of Visitor and Tour Services, University of Richmond Museums*

2:45 – 3:00 pm: Break: Please visit our Sponsor Tables, Poster Sessions and Silent Auction



Strategic Planning Category Sponsor: Gund Gallery Board of Directors
Afternoon Coffee Break Sponsor: US Art

■ Session 3, 3:00 pm – 4:15 pm

Facility Renovations, Location Challenges, and New Models

Cedar + Spruce Room

Category: Renovations, Old and New Facilities

Planning for Success: The Fowler Museum Project

Erin Flynn, Cooper Robertson, and David Blair, Deputy Director, Fowler Museum

Renovation and Reinvention: The New Doug Adams Gallery at the Graduate Theological Union, Berkeley:

Elizabeth Peña, Director, Center for the Arts & Religion (CARE), and Doug Adams Gallery, Graduate Theological Union, Berkeley

The Alford Inn at Rollins College: *Ena Heller, Brice A. Beal Director, Cornell Fine Arts Museum, Rollins College*

New Partners, New Programs

Maple Room

Category: New Partners, Programs, and Practice

A Natural Partnership: Osher Lifelong Learning Institutes and Campus Museums:

Carin Jacobs, Director, Lifelong Learning Programs, Sonoma State University

Military and Veteran-connected Communities in Dialogue: A Case Study of Best Practices in Community-based Programming and Exhibition Practice:

Chelsea Farrar, Curator of Community Engagement, University of Arizona Museum of Art, and Willa Ahlschwede, MA student, Art and Visual Culture Education, University of Arizona

Art from the Inside: *Lee Fearnside, Associate Professor of Art and Gallery Director, Diane Kidd Gallery, and Dr. Steven Hurwitz, Professor of Psychology and Counseling, Tiffin University*

How to Integrate the Arts into a Medical School's Curriculum: *Rochelle Caruthers, University Academic Programs Coordinator, Mildred Lane Kemper Art Museum, Washington University, St. Louis, and Lisa Abia-Smith, Director of Education, JSMA*

Who Wants to Talk? Communicating the How and Why of Teaching with Objects

Ballroom

Category: Curricular Connections/Collections

Nicole Crawford, Curator of Collections, University of Wyoming; Dr. Jim Harris, Mellon Foundation Curator, University Engagement Programme, Ashmolean Museum of Art and Archaeology, Oxford University; Elizabeth Manekin, Head of University Programs and Academic Projects, Ackland Art Museum, University of North Carolina; and Dr. Isadora Helfgott, Associate Professor History, University of Wyoming

The Art of Craft Beer: Brewing Beer and Building Audiences

Swindells Room

Category: New Partners, Programs, and Practice

Erik L. Peterson, Manager of Family Programs and Student Engagement, Smart Art Museum, University of Chicago; Stephanie Parrish, Associate Director of Education and Public Programs, Portland Art Museum; Eric Steen, Founder, Beers Made by Walking; Mary Szaroleta, Associate Curator of Public Programs, Museum of Fine Arts, St. Petersburg, FL; and Lauren Willis, Programs and Exhibits Manager, Museum of Natural and Cultural History, University of Oregon

6:00 pm on: Affinity-themed no-host dinners

event is full, pre-registration required

★ Facility Renovations, Location Challenges, and New Models Session Sponsor: Cooper Robertson
New Partners, Programs & Practice Category Sponsor: Gund Gallery Staff and Associates

RANGE OF ANTI-REFLECTIVE ACRYLIC AND GLASS SOLUTIONS

For Protection & Display of Cultural Heritage and Fine Art Collections

Optium Museum Acrylic®

UltraVue® Laminated Glass

TruLife® Anti-Reflective Acrylic
for Face / Second Surface Mounting, Signage, and Print Applications

APPLICATIONS INCLUDE:
VITRINES • GLASS DISPLAY CASES • CABINET DOORS • WALL NICHES
BOX FRAMES • STAND-OFFS • EXHIBIT SIGNAGE • TRADITIONAL FRAMING

For samples or questions, visit tru-vue.com/museums-collections or contact fineart@tru-vue.com.



Mr. Morgan's Library (East Room). After restoration. The Morgan Library & Museum, New York, USA. Photography by Graham Haber, 2010.



Photo credit: Kris Iverson, Moon Shadow Glass.



Photo courtesy Groeningemuseum.

TRUSTED ACRYLIC & GLASS SOLUTIONS FOR OVER 45 YEARS



ANTI-REFLECTIVE | ABRASION RESISTANT | CONSERVATION GRADE UV PROTECTION | COLOR NEUTRAL | SAFETY & SECURITY

Tru Vue®, the Tru Vue logo, Optium Museum Acrylic®, UltraVue® Laminated Glass and TruLife® are registered trademarks of Tru Vue, Inc, McCook, IL USA. © 2017 Copyright Tru Vue, Inc. All rights reserved.

www.artworkfas.com



Seattle, Washington
scotty@artworkfas.com
(206) 762-4040



Portland, Oregon
michael@artworkfas.com
(503) 256-7648



Installation | Crating | Shipping | Storage | West Coast Shuttle

8:30 am: Registration Opens

9:00 – 9:45 am: Introduction of Wendy Red Star by Jennifer O’Neil,
*Corrigan Solari University Historian and Archivist and Instructor, Robert D. Clark
Honors College and Native Studies Program*

Keynote: Wendy Red Star

9:45 – 10:15 am: Dialogue with Wendy Red Star, facilitated by Leanne Gilbertson,
Gallery Director, Northcutt Steele Gallery, Montana State University, Billings

10:15 – 10:45 am: Break: Please visit our Sponsor Tables, Poster Sessions and Silent
Auction; Book signing (**Exhibit Makeovers** by Alice Parman)

■ Session 1, 10:45 am – 12 noon

**Partnering for Professional Development:
Supporting the Next Generation of Museum
Professionals**

Oak Room

Categories: Curricular Connections; Administration,
Strategic Planning, and Fundraising; and New Partners,
New Audiences

*Andrew Gelfand, Anne Lunder Leland Curatorial Fellow,
Colby College Museum of Art; Justin McCann, Lunder
Curator for Whistler Studies, Colby College Museum of Art;
Caitlin Rogers, student, collections intern, Colby College;
Honor Wilkinson, Curatorial Assistant and Manager of
Student Programs, Bowdoin College Museum of Art*

**Developing, Sustaining and Revitalizing the
Teaching Museum**

Cedar + Spruce Room

Category: Curricular Connections

*Christian Carr, Professor of Art History, Savannah College
of Art and Design; Danielle M. Knapp, McCosh Associate
Curator, JSMA; and Amanda York, Assistant Curator,
Savannah College of Art and Design Museum of Art*

**The Phantom Punch: Integrating Innovative
Knockout Contemporary Art Programming
into College, Public School and Community
Audiences**

Ballroom

Category: Curricular Connections/New Partnerships

*Dan Mills, Director, Bates Museum of Art; Stephen
Stapleton, CULTURUNNERS; and Anthony Shostak,
Education Curator, Bates Museum of Art*

**Don’t Forget Your Umbrella! Success within a
Parent Institution**

Maple Room

Category: Administration, Strategic Planning, and
Fundraising

*Scott H. Harris, Director, The James Monroe Museum,
Fredericksburg, Virginia; Keidra Daniels Navaroli,
Assistant Director and Curator, Ruth Funk Center for
Textile Arts, Florida Institute of Technology; and John
Wetenhall, Director, The George Washington University
Museum & The Textile Museum*

12:00 – 1:30 pm: Buffet Lunch, Please visit our Sponsor Tables, Poster Sessions and Silent Auction

Plenary & Keynote Sponsor: Mid-America Arts Alliance ★

Lunch Sponsor: Institute of Texan Cultures

■ Session 2, 1:30pm – 2:45 pm

University Museums and First-Year Readings**Maple Room**

Category: Curricular Connections

Cheryl Hartup, Associate Curator of Academic Programs and Latin American Art, JSMA; Barbara Rothermel, Director, Daura Gallery, Lynchburg College; Howard Graham, Associate Director for Academic Programs, Spencer Museum of Art; and Sara DeWaay, Art and Architecture Librarian, UO Libraries

Doing More with Less: Finding and Stretching Resources in Lean Times**Cedar + Spruce Room**

Category: Administration, Strategic Planning and Fundraising; Governance and Advocacy

Jeffrey Bowen, Director, University of Houston-Clear Lake Art Gallery; Brian McGovern, Associate Director for Advancement, Yale University Art Museum; Leah Niederstadt, Assistant Professor of Museum Studies & Curator of the Permanent Collection, Wheaton College; Donna Sewell, Manager, Visitor Services, Ruth Funk Center for Textile Arts, Florida Institute of Technology

Student-Curated Exhibitions**Ballroom**

Category: Curricular Connections

Dr. Jodi Kovach, Curator of Academic Programs, Gund Gallery, Kenyon College; Pamela Franks, Deputy Director of Exhibitions, Programming, and Education, and Seymour H. Knox, Jr., Curator of Modern and Contemporary Art, Yale University Art Museum; Amelia Kahl, Associate Curator of Academic Programming, Dartmouth College; and Anne Rose Kitagawa, Chief Curator, Curator of Asian Art, and Director of Academic Programs, JSMA

TEACH VISUAL: Sharing Object-Based Teaching Tools**Swindells Room**

Category: Curricular Connections/Technology

Craig Hadley, Director/Curator, The Galleries at Peeler, DePauw University; Andria Derstine, Director, Allen Memorial Art Museum, Oberlin College; and Kitty McManus Zurko, Director/Curator, The College of Wooster Art Museum



2:45 – 3:00 pm: Break: Last Chance Silent Auction,
Sponsor Tables and Poster Sessions



TEACH VISUAL Session Sponsor: American Elements
Fundraising for the Academic Museum Sponsor: Spacesaver
Break Sponsor: Cultural Strategy Partners

■ Session 3, 3:00pm – 4:15 pm

**Certificates, Masters Programs, and More:
Training For Museum Professionals**

Cedar + Spruce Room

Category: Curricular Connections/Professional Training

Museum Masters Review: How Do Museum Graduate Programs Stack Up? *Sarah Taubner, North Carolina Museum of Natural Sciences, Raleigh, and Museum of Life and Science, Durham*

NIU Art Museum Studies Graduate Certificate Program: *Peter Olson, Assistant Director, Northern Illinois University Art Museum*

The KU Arts Engagement Certificate: *Raechel Cook, Program Coordinator for Experiential Learning, The University of Kansas*

MA and Ph.D. in Museum Education and Visitor-Centered Exhibitions (MEX): *Pat Villeneuve, Professor and Director of Arts Administration, Florida State University, and John Jay Boda, doctoral student, MEX and filmmaker, Florida State University*

First Folio at University Art Museums

Swindells Room

Category: New Partners, New Audiences, Curricular Connections

Setting the Stage: *Jessica Brunecky, Director of Visitor Experience, University of Colorado Art Museum; Hope Saska, Curator of Collections and Exhibitions, University of Colorado*

Eyes on Shakespeare: *Meredith Peruzzi, Manager and Curator, Gallaudet University Museum, Gallaudet University; and Dr. Jill Bradbury, Professor, Department of English, Gallaudet University*

Negotiating Tangible Gifts: Policy, Process, and Real Life

Maple Room

Category: Administration, Strategic Planning, and Fundraising; Governance and Advocacy; Collections

Panelists: *Jeff Elliott, Associate Director, Arts and Sciences Advising, University of Tennessee; Julie Hart, Senior Director, Museum Standards & Excellence, American Alliance of Museums; Jamaal Sheats, Director & Curator of Fisk University Galleries and Assistant Professor of Art; Lauren McHolm, recent MBA graduate and former Executive Assistant and Operations Manager in the Office of the UO General Counsel; and Grady Goodall, Director of Development for the OSU College of Liberal Arts*

**Strategic Planning for the Teaching Museum:
The University of Arizona Museum of Art Case Study**

Ballroom

Category: Strategic Planning

Olivia Miller, Curator of Exhibitions and Education; Chelsea Farrar, Curator of Community Engagement; Art and Visual Culture Education, Dr. W. James Burns, Director, University of Arizona Museum of Art; Dr. Natasha S. Reid, Executive Director of the Visual Arts Centre (former Assistant Professor, University of Arizona)



5:00 pm - 7:00 pm: **Museum Tours and Receptions**

Enjoy special tours and refreshments at both the Museum of Natural and Cultural History and the Jordan Schnitzer Museum of Art. Start at the JSMA and join the artwalk to MNCH at 5:45 pm (MNCH reception opens at 6:00 pm)

Museum Tours and Receptions Sponsors: Bonhams, Art Work Fine Art Services ★

Negotiating Tangible Gifts Policy, Process and Real Life Session Sponsor: Cultural Strategy Partners

“For me, waking up each day without art around me would be like waking up without the sun. When you live with art around you, your mind and soul are filled with the beauty of life and the creativity of the human spirit.”

– JORDAN D. SCHNITZER

A PASSION FOR SHARING ART

Established in 1997, the Jordan Schnitzer Family Foundation has organized over 100 exhibitions in over 100 museums of post-WWII prints and multiples by American artists from Jordan D. Schnitzer and His Family Foundation. The Foundation provides programming for students, seniors, artists in residency and lecture series and the collection is made available at no charge to museums.

Exhibition Inquiries:

Jordan D. Schnitzer
jordans@harsch.com

Catherine Malone
catherinem@harsch.com



The first step in strategic planning?

Coffee!

Cultural Strategy Partners is delighted to host the AAMG Conference breakfast and support the only organization committed to advancing academic museums



CULTURAL STRATEGY PARTNERS

Strategic Planning ♦ Organizational Focus
Performance Metrics

Tom Shapiro

TShapiro@CulturalStrategyPartners.com

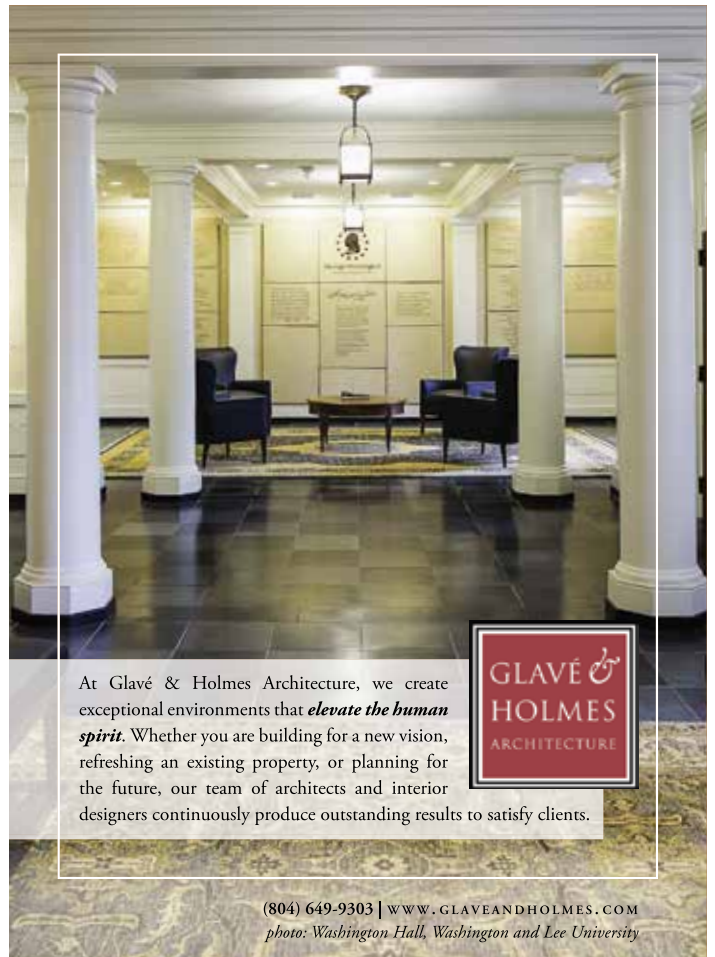

At Glavé & Holmes Architecture, we create exceptional environments that *elevate the human spirit*. Whether you are building for a new vision, refreshing an existing property, or planning for the future, our team of architects and interior designers continuously produce outstanding results to satisfy clients.



(804) 649-9303 | WWW.GLAVEANDHOLMES.COM
photo: Washington Hall, Washington and Lee University



© 2017 Bonhams & Butterfields Auctioneers Corp. All rights reserved. Bond No. 57BSBGL0806

Through our dedicated Museum Services program, Bonhams has raised over \$100 million through the sale of vetted deaccessions for hundreds of partner institutions in recent years.

By supporting the deaccession protocols of the AAM, AAMD and ALA, we have built long-standing and successful relationships with museum directors and trustees across North America.

For further information about consigning to upcoming auctions, please contact:

Sheryl Acheson
+1 (503) 312 6023
sheryl.acheson@bonhams.com

Scot Levitt
+1 (323) 436 5425
scot.levitt@bonhams.com

Alan Fausel
+1 (212) 644 9039
alan.fausel@bonhams.com

WALTER UFER
Indian Entertainer
Sold for \$1,025,000
on behalf of a University Museum

Bonhams

AUCTIONEERS SINCE 1793

bonhams.com/museumservices

Sotheby's EST. 1744
Collectors gather here.

Sotheby's is pleased to support the 2017 AAMG Annual Conference

Committed to the Success of the Nation's Great Museums. We assist museums of all sizes and collecting categories with deaccessions, private sales, buying at auction, valuations, cultivation events, and catalogue subscriptions.

1334 YORK AVENUE, NEW YORK, NY 10021
ENQUIRIES +1 212 894 1138 SOTHEBYS.COM/MUSEUMSERVICES
SOTHEBY'S, INC. LICENSE NO. 1238084 © SOTHEBY'S, INC. 2017



DOWNLOAD SOTHEBY'S APP
FOLLOW US #SOTHEBYS



Poster Sessions (during breaks)

Hattie Saussy: Rediscovery of an Artist, a Curator/ Student Collaboration

John Daniel Tilford, Curator of Collections, and Larissa M. Randall, BA student, Oglethorpe University Museum of Art

Liberacion para siempre: Exhibitions for Interdisciplinary Engagement

Youmi Kim Efur, Adjunct Professor, Wofford College

Re-establishing Intellectual Control: The African Art Collection Project at the University of Central Oklahoma

Shikoh Shiraiwa, Library Technician, Archives & Special Collections, Max Chambers Library, University of Central Oklahoma

Object Lessons, or How to Exhibit 200 Years of Scientific Collecting at a Major Public University

Kerstin Barndt, Associate Professor, University of Michigan

If Musical Instruments Could Talk: The National Music Museum in Service to its University Community

Deborah Check Reeves, Curator of Education and Woodwinds, National Music Museum

Towards Truth and Reconciliation: Contributing to Something Big through the Programs at a Small Canadian University Art Gallery

Gillian Booth, Academic and Community Programmer and Caroline Riedel, Curator, University of Victoria Legacy Art Galleries

A "Guide to Looking," or How to Research Objects at the Peabody Museum

Emily Pierce Rose, Curatorial Assistant for Academic Partnerships, and Lainie Schultz, Academic Partnerships Coordinator, Peabody Museum of Archaeology and Ethnology, Harvard University

New Student Clubs

Oregon State University students

Thank You.

The Jordan Schnitzer Museum of Art and the Museum of Natural and Cultural History thank Doug Blandy, Senior Vice Provost for Academic Affairs, University of Oregon, for his generous leadership support of this year's conference.

JORDAN SCHNITZER
MUSEUM OF ART



UNIVERSITY OF
OREGON



ExhibitsUSA and NEH on the Road exhibitions
organized and traveled by Mid-America Arts Alliance

View our entire portfolio at eusa.org and nehontheroad.org

ExhibitsUSA



2018 BALTIMORE AVE., KANSAS CITY, MISSOURI 64108 | WWW.MAAA.ORG | 1-800-473-3872

Clockwise from upper left: Harold Feinstein (American, born 1901), Copy (After Fremoyers) (detail), 1940s, gold leaf on paper, original 26 x 38 inches; Harold Feinstein (Photograph), 1940s; Abstract (from series of Abstracts) (also known as Water level), 1940s, manufactured by Wiro, Netherlands; Dutch-Wind (black on cotton), 48 x 52 inches; Courtesy of Bradsher Beavers Collection; Danish Gallop, Knud (AKA as our (detail), Rosenswärd, Lividity 1860s, ink jet print; © Galley Beatty Family Collection; Gilda, Condoristi (Ceramics) (detail), 1992, acrylic on canvas, 29 x 27 inches; courtesy Con/Visa - Popular Arts of the Americas; © Dublin Image/Paul Penner



Art can be minimal.
Its protection shouldn't be.

TRAVELERS
It's better under the umbrella®

travelers.com

© 2017 The Travelers Indemnity Company. All rights reserved. Travelers and the Travelers Umbrella logo are registered trademarks of The Travelers Indemnity Company in the U.S. and other countries. BIMAD.0002-2 New 5-17

■ 4 Morning Workshops, 9:00am - 12:00 noon - JSMA

**STEPS TO ACCREDITATION:
CORE DOCUMENTS: \$50**

Julie Hart, Senior Director, Museum Standards & Excellence, American Alliance of Museums

**EFFECTIVE DIGITAL CONTENT STRATEGIES
FOR THE SMALL, OVERWORKED STAFF: \$150**

Presenter Douglas Perkins, Operations Manager at the Middlebury College Museum of Art

**THINKING OUTSIDE THE [MUSEUM] BOX:
UNDERSTANDING YOUR CURRENT AND
POTENTIAL VISITORS: \$150**

Lynn Dierking and John Falk

Find Yourself Here.



UTSA INSTITUTE OF TEXAN CULTURES



Smithsonian Affiliate

801 E. César E. Chávez Blvd. San Antonio, TX 78205-3296

210-458-2300 ★ TexanCultures.com

Thursday's Excursions

The Oregon Coast

We visited the historic Heceta Head Lighthouse, descend 200 feet by elevator into North America's largest sea cave brimming with bellowing sea lions, and come back through Florence, where you can amble the boardwalk and watch incoming fishing boats, shop the boutiques, and indulge in fine local dining at riverfront restaurants in the historic riverfront town.

Wine Tasting: The Best of the South Willamette Valley

Often ranked as a top wine destination, the South Willamette Valley is criss-crossed with scenic wine trails. We enjoyed a leisurely day in Oregon Wine Country with tastings at Sweet Cheeks Winery, Silvan Ridge Winery, and King Estate Winery.

Thursday Excursions facilitated by
Best Oregon Tours
www.bestoregontours.com
(503) 572-5323



Sunday's Excursions



River Rafting facilitated by:
Helfrich River Outfitter Inc.
www.helfrichoutfitter.com
 (800)-507-9889

Half Day of McKenzie River Rafting with Helfrich Outfitter!

Finn Rock to Helfrich: 9.5 miles, 3 hours on the river and 6 hours (round trip) from Eugene

Whether you're a novice or an experienced rafter, this white water rafting excursion starts with team paddling and learning what to do. Then we'll enter the great wave-train rapids—lots of wet, white water excitement. A little later comes Brown's Hole, which drops into a pool of effervescent turquoise water. Martin's, the river's most famous rapid, comes next, and we'll use the maneuvering skills honed over the past nine miles.

Bus departs at 12:30 pm and returns at 6:30 pm.

\$75 includes transportation, box lunch, river guide + gratuity.

Waiting list only, please see registration table.

Explore the Eugene, Cascades & Coast region of Oregon!

In this adventure-driven destination, find yourself hiking to spectacular waterfalls or endless public beaches, kayaking white water or ocean estuaries, cycling through wine country or on Oregon's best trails, and while you're here, don't forget to sample the premier culinary bounty that awaits!

Find out more here: www.eugenecascadescoast.org/aamg

2017 AAMG Board of Directors

Jill Hartz, President and Vice President, Programs
president@aamg-us.org
vp-programs@aamg-us.org

Lisa Tremper Hanover, President Emerita
lhanover@michenerartmuseum.org

David Robertson, President Emeritus
DavidNorthwestern@yahoo.com

Dr. Anja Chavez, Secretary
secretary@aamg-us.org

Joseph Mella, Treasurer
treasurer@aamg-us.org

Dan Mills, Vice President – Membership
membership@aamg-us.org

Dr. Jill Deupi, Vice President – State & Regional Representatives
vp-regionals@aamg-us.org

Craig Hadley, Vice President – Communications
communications@aamg-us.org

Kristina Durocher, New England Regional Representative
new-england-rep@aamg-us.org

Denise Stangl, Mid-Atlantic Regional Representative
mid-atlantic-rep@aamg-us.org

Scott Harris, Southeast Regional Representative
southeast-rep@aamg-us.org

Dr. Natalie Marsh, Midwest Regional Representative
midwest-rep@aamg-us.org

John Versluis, Mountain-Plains Regional Representative
mountain-plains-rep@aamg-us.org

Katie Lee Koven, Western Regional Representative
western-rep@aamg-us.org

Lynn Marsden-Atlas, At-Large, Nominating Chair
lmatlass@upenn.edu

Michiko Okaya, At-Large, Finance
okayam@lafayette.edu

Dr. Barbara Rothermel, At-Large, Conference Sponsorship
Rothermel@lynchburg.edu

Tom Shapiro, Strategic Planning
TShapiro@CulturalStrategyPartners.com

Jamaal Sheats, At-Large, Student Engagement
jsheats@fisk.edu

Dr. Brent Tharp, Council of Affiliates
btharp@Georgiasouthern.edu

Dr. John Wetenhall, Strategic Planning
jwetenhall@email.gwu.edu

Incoming AAMG Board of Directors (June 2017-)

Proposed Slate:

John Versluis, President
president@aamg-us.org

Dr. Anja Chavez, Secretary
secretary@aamg-us.org

Joseph Mella, Treasurer
treasurer@aamg-us.org

John Wetenhall, Vice President Strategic Planning
vp-strategic @aamg-us.org

Tracy Fitzpatrick, Vice President – Programs
vp-programs@aamg-us.org

Dan Mills, Vice President – Membership
membership@aamg-us.org

Katie Lee Koven, Vice President State & Regional Representatives
vp-regionals@aamg-us.org

Craig Hadley, Vice President – Communications
communications@aamg-us.org

Board Approved:

Kristina Durocher, New England Regional Representative and Nominating Chair
new-england-rep@aamg-us.org
nominating@aamg-us.org

Denise Stangl, Mid-Atlantic Regional Representative
mid-atlantic-rep@aamg-us.org

Scott Harris, Southeast Regional Representative
southeast-rep@aamg-us.org

Dr. Natalie Marsh, Midwest Regional Representative
midwest-rep@aamg-us.org

Nicole Crawford, Mountain-Plains Regional Representative (Northern States)
mountain-plains-rep@aamg-us.org

Angelica Docog, Mountain-Plains Regional Representative (Southern States)
mountain-plains-rep@aamg-us.org

Anna-Maria Shannon, Western Regional Representative
western-rep@aamg-us.org

Judith Kirk, At-Large, Conference Sponsorship
sponsorship@aamg-us.org

Jamaal Sheats, At-Large, Student Engagement
jsheats@fisk.edu

Dr. Jordana Pomeroy, At-Large, Diversity
diversity@aamg-us.org

Dr. Jill Deupi, At-Large, CAA/AAMD Liaison
jdeupi@miami.edu

Dr. Lana Burgess, At-Large, Professional Development
lburgess@mailbox.sc.edu

Tom Shapiro, At-Large, Advocacy and Affiliates
TShapiro@CulturalStrategyPartners.com

Pamela Campanaro, At-Large, Conference Planning
Pamela.Campanaro@unco.edu

Jill Hartz, President Emeritus
hartz@uoregon.edu

AAMG Staff and Volunteer

Lauren Basing, Membership Coordinator
membership@aamg-us.org

Alexandra Chamberlain, Social Media Manager
socialmedia@aamg-us.org

Mike Bragg, Program Design & Photography
mbragg@uoregon.edu

For State Representatives, please see our website.

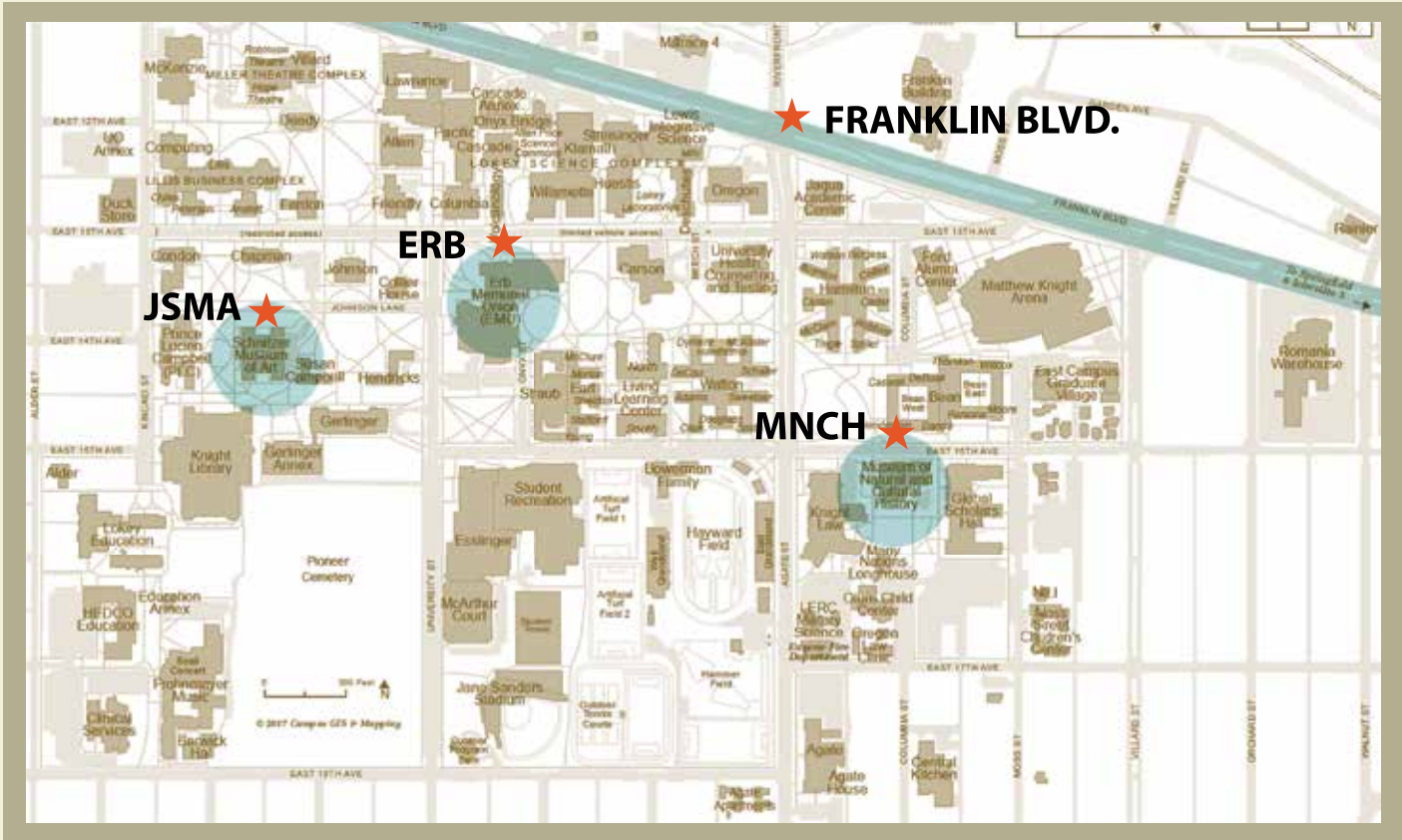

Thanks to our sponsors

**COOPER
ROBERTSON**

JS JORDAN SCHNITZER
FAMILY FOUNDATION
jordanschnitzer.org

KRESS

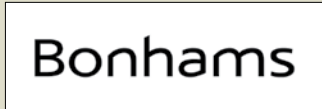

Registrants *(as of June 5)*

Lisa Abia-Smith

Director of Education and Outreach
Jordan Schnitzer Museum of Art
Presenter

Andrea Alaniz

Graduate Assistant
Diane Kidd Gallery

Robyn Anderson

Education Coordinator
Museum of Natural and Cultural History
Presenter

Clover Archer Lyle

Gallery Director
Staniar Gallery

Carey Beam

Director
Wylie House Museum

David Blair

Deputy Director
Fowler Museum
Presenter

Laura Blereau

Curator
Paul & Lulu Hilliard University Art Museum

Gillian Booth

Academic and Community Programs Coordinator
Legacy Galleries
Presenter

Jessica Brunecky

Director of Visitor Experience
CU Art Museum
Presenter

Liz Canter

Academic Programs Coordinator
Tufts University Art Gallery
Presenter

Laura Child

Director of Development
Museum of Art/WSU

Sonnet Coggins

Associate Director for Academic and Public Engagement
Williams College Museum of Art

Linda Corbin-Pardee

Senior Student Services Coordinator
Union Art Gallery

Nicole Crawford

Curator of Collections
UW Art Museum
AAMG Mountain-Plains Rep, Presenter

Sheryl Acheson

Regional Representative
Sponsor

Angelee Allman

Gallery Attendant
The Art Gym
Kress Foundation Scholarship

Shannon Annis

Exhibitions Manager and Registrar
Contemporary Art Museum
Presenter

Olivia Arnold

Business Operations Manager
Paul W. Bryant Museum

Ryan Bennert

Student Outreach and Membership Coordinator
Nasher Museum of Art

Doug Blandy

Senior Vice Provost for Academic Affairs
Sponsor

Jessica Bocinski

Art Collections Assistant
Chapman University Art Collections Department
Four Color Print Group Scholarship

Jeffrey Bowen

Director
University of Houston-Clear Lake Art Gallery
Presenter

Lana Burgess

Associate Clinical Professor
McKissick Museum

Christian Carr

Professor
SCAD Museum of Art
Presenter

Michael Christiano

Interim Senior Director of Museum Programs
Smart Museum of Art
Presenter

Alecia Conrad

Second Grade Teacher, Art Teacher
Presenter

Laura Cotton

Art Curator and Gallery Manager
Alfred Berkowitz Gallery

Tonya Curran

Gallery Director
Hand Art Center

Willa Ahlschwede

Graduate Student
Arts and Visual Culture Education
Kress Foundation Scholarship, Presenter

Laura Amussen

Director of Exhibitions and Curator
Rosenberg and Silber Art Galleries

Kay Antonelli

Assistant Superintendent for Instruction
Presenter

Kerstin Barndt

Associate Professor
Museum Studies Program
Presenter

Heather Bennett

Collections Manager
Forsyth Galleries

Steven Blashfield

Cultural Studio Director
Glavé & Holmes
Sponsor

John Jay Boda

Graduate Student
Museum Education and Visitor-Centered Programs
Kress Foundation Scholarship, Presenter

Mike Bragg

Design Services Manager
Jordan Schnitzer Museum of Art

James Burns

Executive Director
The University of Arizona Museum of Art
Presenter

Rochelle Caruthers

University Academic Programs Coordinator
Mildred Lane Kemper Art Museum
Presenter

Christian Clark

Interim Director of Education and Interpretation
Institute of Texan Cultures
Sponsor

Raechel Cook

Program Coordinator for Experiential Learning
Undergraduate Studies
Presenter

Elizabeth Coulter

Curatorial Fellow
Cornell Fine Arts Museum
Kress Foundation Scholarship

Kim Datchuk

Assistant Curator of Special Projects
Museum of Art

Jennie Davy
Exhibits Manager
Special Collections Research Center

Sally Delgado
Curator of Education
Kennedy Museum of Art

Andria Derstine
John G. W. Cowles Director
Allen Memorial Art Museum
Presenter

Erin Díaz
Assistant Professor of Spanish
Trout Gallery
Presenter

Maggie Dimock
Curator of Collections and Exhibitions
Alva de Mars Megan Chapel Art Center

Juliana Dweck
Andrew W. Mellon Curatorial Fellow for Collections
Princeton University Art Museum
Presenter

Youmi Efurd
Curator
Sandor Teszler Library Gallery
Presenter

John Falk
Director
Presenter

Eva Fierst
Curator of Education
University Museum of Contemporary Art

Heather Flaherty
Curator of Education
The Trout Gallery
Presenter

Pamela Franks
Senior Deputy Director and the Seymour H. Knox Jr.
Curator of Modern and Contemporary Art
Yale University Art Gallery
Presenter

Andrew Gelfand
Anne Lunder Leland Curatorial Fellow
Colby College Museum of Art
Presenter

Grady Goodall
Director of Development
College of Liberal Arts
Presenter

Howard Graham
Associate Director for Academic Programs,
Office of First-Year Experience, Spencer Museum of Art
Presenter

Brittany Halberstadt
Education Assistant for the Reflections Program
Nasher Museum of Art
CultureSpots Scholarship

Andrea DeHaan
Administrative and Events Coordinator
Nora Eccles Harrison Museum of Art

Julie Delliquanti
Manager of Public Programs and Interpretation
Cantor Arts Center

Jill Deupi
Director and Chief Curator
Lowe Art Museum
AAMG Board Member

Julie Dickover
Museum Director
Crisp-Ellert Art Museum

Paul Dobkowski
Western Account Manager
Sponsor

Samantha Eads
Graduate Certificate Student, Visitor Services Manager
Museum of Natural History

William Eiland
Director
Georgia Museum of Art
Presenter

Chelsea Farrar
Curator of Community Engagement
University of Arizona Museum of Art
Presenter

Marianna Finke
International Student and Scholar Services
Jordan Schnitzer Museum of Art

Erin Flynn
Senior Associate
Cooper Robertson
Presenter

Carla Funk
Director of University Museums
Foosner Art Museum
Presenter

Leanne Gilbertson
Director
Northcutt Steele Gallery

Robin Goodman
Collections Manager and Registrar
Gund Gallery
Sponsor

Dustin Growick
Audience Development and Team Lead for Science

John Handley
Director
SFASU Art Galleries / Cole Art Center

Christy DeLair
Assistant Curator
Longyear Museum of Anthropology
Presenter

Breanna DeMontigny
Masters Student
Jordan Schnitzer Museum of Art
Travelers Scholarship

Sara DeWaay
Art and Architecture Librarian
Architecture & Allied Arts Library
Presenter

Lynn Dierking
Director for Strategy and Partnerships
Presenter

Angelica Docog
Executive Director
Institute of Texan Cultures
AAMG Mountain-Plains Rep, Sponsor

Phillip Earenfight
Director
The Trout Gallery

Jeff Elliott
Associate Director, Arts and Sciences Advising
Presenter

Lee Fearnside
Director
Diane Kidd Gallery
Presenter

Tracy Fitzpatrick
Director
Neuberger Museum of Art
AAMG VP - Programs

Christine Fogarty
Associate Director
Global Museum

Amber Geary
Andrew W. Mellon Educator for School and
Community Programs
Ruth and Elmer Wellin Museum of Art
Presenter

Megan Glazier-Anderson
Collections Assistant
World of Speed

Colleen Gotze
Registrar and Program Coordinator
Douglas F. Cooley Memorial Art Gallery

Craig Hadley
Director and Curator of Exhibitions and University
Peeler Art Center Galleries
AAMG VP - Communications, Presenter

Erin Hanke
Director
Edward A. Whitney Gallery

Stephanie Hanor

Director
Mills College Art Museum
Presenter

Jim Harris

Andrew W Mellon Foundation Teaching Curator
Ashmolean Museum of Art and Archaeology
Presenter

Cheryl Hartup

Associate Curator of Academic Programs and
Latin American Art, Jordan Schnitzer Museum of Art
Presenter

Isadora Helfgott

Associate Professor, Curator of Academic Engagement
UW Art Museum
Presenter

Jeffrey Hirsch

Principal Architect

Sarah Hopley

Special Collections and Exhibits Librarian,
Assistant Professor, Wraether West Kentucky Museum
Presenter

Sarah Howard

Curator of Public Art and Social Practice
USF Contemporary Art Museum
Presenter

Carin Jacobs

Director
Osher Lifelong Learning Institute
Presenter

Catalina Jarmillo Phillips

Exhibition Designer
Jewish Museum of Florida
Kress Foundation Scholarship

Sarah Joseph

Director of Exhibitions
The Fed Galleries

Caitlin Margaret Kelly

Director
Power Plant Gallery

Judith Kirk

Assistant Director
Mathers Museum of World Cultures
AAMG Board Member, Presenter

Peter Konstantinidis

Curator of Vertebrates and Ichthyoplankton Specialist
Department of Fisheries and Wildlife
Presenter

Rebekah Lambert

Vice President
Arts Consulting Group

Ann Layton

Fine Art Segment Lead, National Director Professional
Development Inland Marine
Sponsor

Ryan Hardesty

Curator of Art and Exhibitions
Museum of Art

Gabriel Harrison

Exhibitions Manager
Department of Art & Art History

Jill Hartz

Executive Director
Jordan Schnitzer Museum of Art
AAMG President Emeritus, Presenter

Ena Heller

Bruce A. Beal Director
Cornell Fine Arts Museum
Presenter

Kelley Hirsch

M.Ed. Candidate

Sarah Horowitz

Curatorial Assistant
Picker Art Gallery and Longyear
Museum of Anthropology
Presenter

Jessica Hunter-Larsen

Curator
Colorado Springs Fine Arts Center

Rebecca Jacobs

Digital Resources Assistant
Indiana Historical Society
Kress Foundation Scholarship

Carolyn Jenkinson

NEH Project Coordinator
Logan Museum of Anthropology
Presenter

Amelia Kahl

Associate Curator of Academic Programming
Hood Museum of Art
Presenter

Lisa Kemmis

Museum Assistant
Jim Crow Museum

Anne Rose Kitagawa

Chief Curator of Collections and Asian Art,
Director of Academic Programs
Jordan Schnitzer Museum of Art
Presenter

Jodi Kovach

Curator of Academic Programs
Gund Gallery
Presenter

Yadin Larochette

Museum and Conservation Liaison
Sponsor

Jamie Leaf

Visitor Services and Facility Rental Coordinator
Jordan Schnitzer Museum of Art
Presenter

Scott Harris

Director
The James Monroe Museum
AAMG Southeast Rep, Presenter

Julie Hart

Sr. Director, Standards and Excellence
Presenter

Sarah Hatcher

Head of Programs and Education
Mathers Museum

Nell Herbert

Gallery Manager
Thacher Gallery

Patricia Hobbs

Associate Director, Curator of Art and History
University Collections of Art & History

Robin Howard

Associate Director
James E. Lewis Museum of Art

George Jacob

President and CEO
Aquarium of the Bay

Tabitha Jacques

Director
Dyer Arts Center

Heather Johnson

Gallery Manager
Sarah Spurgeon Gallery
Presenter

Jonathan Kelley

Graduate Student
Museum and Exhibition Studies
Kress Foundation Scholarship, Presenter

Margaret Keough

Director of Marketing and Communications
Sponsor

Danielle Knapp

McCosh Associate Curator
Jordan Schnitzer Museum of Art
Presenter

Christina Kreps

Associate Professor of Anthropology, Director of Museum of Anthropology
University of Denver Museum of Anthropology

Natalie Lawler

Curator
University Art Collections

Katie Lee Koven

Executive Director
Nora Eccles Harrison Museum of Art
AAMG VP – State and Regional Representatives

Annette LeZotte

Director
Kauffman Museum

Julie Lohnes

Curator of Art Collections and Exhibitions
Mandeville Gallery

Leslie Luebbers, PhD

Director
Art Museum of the University of Memphis

Paul Manoguerra

Director and Curator
Jundt Art Museum
Presenter

Christopher Marshall

Curator and Collection Manager
Arthropod Collection
Presenter

Zachary Mazur

Curator of Education and Collections
Museum of Art

Brian McGovern

Associate Director of Advancement
Yale University Art Gallery
Presenter

Nicolette Meister

Acting Director and Curator of Collections
Logan Museum of Anthropology
Presenter

Allison Meyette

Curatorial Intern
Permanent Collection
Kress Foundation Scholarship

Olivia Miller

Curator of Exhibitions and Education, PhD Student
The University of Arizona Museum of Art
Presenter

Carrie Morgan

Curator of Academic Programs
Sheldon Museum of Art

Molly Nelson

Account Manager
Sponsor

Leah Niederstadt

Assistant Professor of Museum Studies, Curator
Permanent Collection
Presenter

Peter Olson

Assistant Director
NIU Art Museum
Presenter

Alice Parman

Museum Consultant and Organizational Coach
Sponsor

Jennifer K Lind

Registrar and Collection Manager
University Museum of Contemporary Art

Diana Loren

Director of Academic Partnerships
Peabody Museum

Catherine Malone

Fine Art Collection Manager
Sponsor

Max Marmor

President
Sponsor

Sarah Martin

Curator of Education and Public Programs
Snite Museum of Art
Presenter

Justin McCann

Lunder Curator for Whistler Studies
Colby College Museum of Art
Presenter

Lauren McHolm

Assistant Director for Finance and Administration
Prevention Science Institute
Presenter

Joseph Mella

Director
Vanderbilt University Fine Arts Gallery
AAMG Treasurer, Presenter

Lee Michels

Leadership Council
Jordan Schnitzer Museum of Art
Presenter

Daniel Mills

Director
Bates College Museum of Art
AAMG VP – Membership, Presenter

Jillian Nakornthap

Exhibitions and Public Programming Associate
Corcoran School of the Arts and Design

Maggie Newey

Associate Director for Academic Programs and Public
Education
Smith College Museum of Art

Michiko Okaya

Director Art Galleries and Collections
Lafayette Art Galleries
Presenter

Susanne Orton

Vice President, Marketing and Communications
Sponsor

Stephanie Parrish

Associate Director of Education and Public Programs
Portland Art Museum
Presenter

Melanie Link-Pérez

Herbarium Curator and Instructor
Department of Botany and Plant Pathology
Presenter

Edward Luby

Director, Museum Studies Professor
Global Museum

Elizabeth Manekin

Head of University Programs and Academic Projects
Ackland Art Museum
Presenter

Natalie Marsh

Director
Gund Gallery
AAMG Midwest Rep, Presenter, Sponsor

Teresa Mayfield

Collection Manager
Biodiversity Collections
Presenter

Doug McGlumphy

Preparator and Collections Manager
The College of Wooster Art Museum

Kitty McManus Zurko

Director and Curator
The College of Wooster Art Museum
Presenter

Jessica Metzger

Harvard Graduate School of Education

Darren Lee Miller

Gallery Director
Bowman-Penelec-Megahan Art Galleries

Laura Minton

Curator of Collections and Exhibitions
Western Carolina University Fine Art Museum
Presenter

Keidra Navaroli

Assistant Director and Curator
Ruth Funk Center for Textile Arts
Presenter

Lauren Nichols

AAMG Conference Coordinator, Masters Candidate
Jordan Schnitzer Museum of Art
Travelers Scholarship, Presenter

Jeffrey Olimpo

Assistant Professor in Biological Sciences
Biodiversity Collections
Presenter

Giulia Pagano

Student Foreign Language Docent
The Trout Gallery
Kress Foundation Scholarship, Presenter

Elaine Patton

Assistant Collection Manager
Sponsor

Elizabeth Peña
Director
Doug Adams Gallery, Center for the Arts & Religion
Presenter

Meredith Peruzzi
Manager and Curator
Gallaudet University Museum
Presenter

Wenjia Qiu
Program Manager
Qian Xuesen Library & Museum

Wendy Red Star
Artist
Presenter

Jennifer Reynolds-Kaye
Cullman-Payson Postdoctoral Fellow
Yale University Art Gallery
Kress Foundation Scholarship, Presenter

Caitlin Rogers
Colby College Museum of Art
Presenter

Roger Rowley
Director
Prichard Art Gallery

Jackie Santa Lucia
Project Architect

Kristin Schimik
Art Handler
Sponsor

Donna Sewell
Manager, Visitor Services
Ruth Funk Center for Textile Arts
Presenter

Jamaal Sheats
Director and Curator of Galleries
Carl Van Vechten Art Gallery and Aaron Douglas Gallery
AAMG Board Member, Presenter

Anthony Shostak
Education Curator
Bates College Museum of Art
Presenter

Jess Simpson
Student
Oregon Museum of Science and Industry
Kress Foundation Scholarship

Joy Sperling
Professor, Art History, Museum Studies
Denison University Museum

Denise Stangl
Operations Administrator
Lehigh University Art Galleries Teaching Museum
AAMG Mid-Atlantic Rep

Douglas Perkins
Operations Manager
Middlebury College Museum of Art
Presenter

Erik Peterson
Manager of Family Programs and Student Engagement
Smart Museum of Art
Presenter

Lisa Quinn
Education Coordinator
Kennedy Museum Of Art

Deborah Reeves
Curator of Education
National Music Museum
Presenter

Caroline Riedel
Curator
University of Victoria Legacy Art Galleries
Presenter

Stefanie Rookis
Curator, Associate Professor
Alabama Museum of Health Sciences

Ashley Rye-Kopec
Curator of Education and Outreach
University Museums

Hope Saska
Curator of Collections and Exhibitions
CU Art Museum
Presenter

Jordan D. Schnitzer
President
Sponsor

Anna-Maria Shannon
Interim Director
Museum of Art
AAMG Western Rep

Fiona Shen
Director
Chapman University Art Collections

Ann Sievers
Director and Curator
Art Museum

Amanda Skinner
Art Gallery Manager
UNE Art Gallery

Charles Stainback
Director
The Philip and Muriel Berman Museum of Art

Peter Stanley
Gallery Manager
Kittredge Gallery

Edmund Warren Perry
Assistant Director
Art Museum of the University of Memphis

Emily Pierce
Curatorial Assistant, Academic Partnerships
Peabody Museum of Archaeology and Ethnology
Presenter

Larissa Randall
Oglethorpe University Museum of Art
Presenter

Natasha Reid
Executive Director
McClure Gallery
Presenter

Richard Rinehart
Director
Samek Art Museum

Barbara Rothermel
Director
Daura Gallery
Presenter

Lori Sams
Gallery Director
Betty Feves Memorial Gallery

Tad Savinar
Artist

Lainie Schultz
Academic Partnerships Coordinator
Peabody Museum
Presenter

Tom Shapiro
Partner
AAMG Board Member, Sponsor

Shikoh Shiraiwa
Library Technician III
Archives and Special Collections
Presenter

Ashley Simmons
PhD Higher Education Student
UK Art Museum & Bolivar Art Gallery
Kress Foundation Scholarship

Theresa Sotto
Assistant Director, Academic Programs
Hammer Museum
Presenter

Kris Stanec
Professor, Department of Education
Colorado Springs Fine Arts Center

Stephen Stapleton
Director and Founder
CULTURUNNERS
Presenter

Cliff Stevens
Founder, President/CEO
Sponsor

Sarah Anne Stolte
Gallery Coordinator and Instructional Lab Specialist
Gallery 211

Mary Szaroleta
Associate Curator of Public Programs
Museum of Fine Arts
Presenter

Greta Taylor
Intern
The Field Museum of Natural History
Kress Foundation Scholarship

Christopher Thompson
Curator in Residence
Champlian College Art Gallery

Brian Trimble
Associate Director
University Art Museum

John Versluis
Dean
Texas Heritage Museum
AAMG President

Shayne Wagner
Associate Leader for Collections
Gund Gallery

Marianne Wardle
Curator of Academic Initiatives
Nasher Museum of Art

Peter Welsh
Professor and Director of Museum Studies

Veronica White
Curator of Academic Programs
Princeton University Art Museum
Presenter

Christy Williams
Vice President
Sponsor

Katie Wolf
Assistant Director
Hanes Art Gallery

Loretta Yarlow
Director
University Museum of Contemporary Art

Sara Stewart
Assistant Director of Development and Marketing
Arthur Ross Gallery

Rachel Straughn-Navarro
Assistant Museum Educator
Museum of Art and Archaeology
Kress Foundation Scholarship

Lucia Täubler
Head of Art Education
Kunstmeile Krems

Sarah Teutimez
Project Manager, Exhibitions and Events
U.S. Art Company
Sponsor

Anne Tiballi
Director of Academic Engagement
Penn Museum

Rebecca Tucker
Associate Professor
Colorado Springs Fine Arts Center

Pat Villeneuve
Professor and Director of Arts Administration
The Ringling
Presenter

Lindsey Wainwright
Coordinator of Academic Programs
McClung Museum of Natural History and Culture

Carey Weber
Assistant Director
Fairfield University Art Museum
Presenter

John Wetenhall
Director
The George Washington University Museum &
The Textile Museum
AAMG VP – Strategic Planning, Presenter

Julie Widholm
Director and Chief Curator
DePaul Art Museum

Debbie Williamson
Communications Manager
Jordan Schnitzer Museum of Art

Martha Wright
Coordinator of Visitor and Tour Services
Harnett Museum/Lora Robins Gallery
Presenter

Dorit Yaron
Deputy Director
David C. Driskell Center

Debbie Stinson
Marketing and PR Manager
Museum of Art/WSU

Leah Sweet
Curatorial Coordinator of Academic Programs
H.F. Johnson Museum of Art
Presenter

Sarah Taubner
Project Archives Assistant and Reviewer
Winona County Historical Society
Kress Foundation Scholarship, Presenter

Brent Tharp
Director
Georgia Southern University Museum

John Daniel Tilford
Curator of Collections
Oglethorpe University Museum of Art
Presenter

Lewis Turley
Associate Leader for Collections
Gund Gallery

Natalie Wadle
Graduate Assistant
CU Art Museum
Kress Foundation Scholarship

Margaret Walker
Assistant Curator
Vanderbilt University Fine Arts Gallery
Presenter

Carrie Weis Stermer
Gallery Director
FSU Fine Art Gallery

Chris White
Collections Manager
Jordan Schnitzer Museum of Art
Presenter

Mary Baily Wieler
President
Museum Trustee Association
Presenter

Lauren Willis
Program and Exhibit Developer
Museum of Natural and Cultural History
Presenter

Lesley Wright
Director
Faulconer Gallery

Amanda York
Assistant Curator
SCAD Museum of Art
Presenter

Internet Access

Registration for access to the UO Wireless network and the internet.

1. On your computer or mobile device, select the UO Guest wireless network. You will be redirected to the UO Guest Connect page.
2. Select Create an account at the bottom of the page.
3. Provide the requested information, check the box indicating you accept the terms and conditions (UO's Acceptable Use Policy), and then click Register.
4. Click Send password via email and/or Send password via text message. (Note: The system may not acknowledge the button click, but it is sending you the message.)
5. Once you've received a message containing your password, click Log in.
6. Enter your assigned username and password. You should then be connected to the UO Guest wireless network.

After the initial registration process, you can use wireless by selecting the UO Guest wireless network on your computer or mobile device and logging in with your assigned username and password, if necessary.

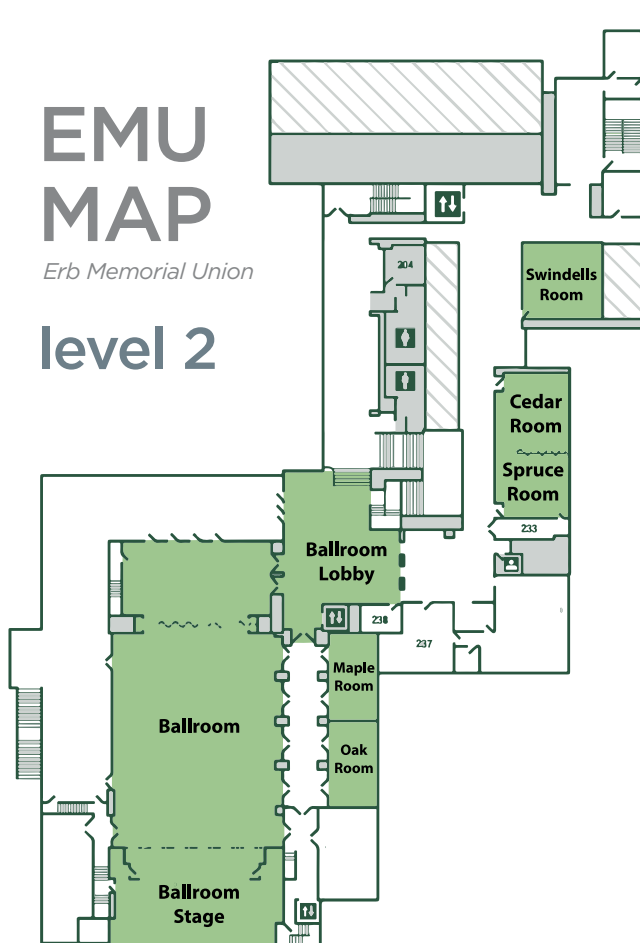

EMU
MAP

Erb Memorial Union

level 2

Contact

For general conference questions, please contact:

Jill Hartz,

hartz@uoregon.edu, 541.868.4138

Lauren Nicols,

lnichols@uoregon.edu, 920.889.1177

Poster Session

Eric Dil,

edil@uoregon.edu, 458.215.5938

Silent Auction

Breanna DeMontigny,

bdemont2@uoregon.edu, 307.689.7677

Technology Needs

Paul Nordquist,

pauldn@uoregon.edu, 541-868-7762